



PAPILLON

Papillon e la gamma di Servetto dedicata alla parte bassa dell'armadio. La filosofia del prodotto prevede un telaio (estensibile o fisso) in cui alloggiare gli accessori per andare a configurare la composizione desiderata. Come tutti i prodotti della gamma Servetto, Papillon è estensibile e si adatta alle dimensioni del vano nelle seguenti modalità: 77-120, 56-80 e 44-56 cm. Il sistema Papillon è compatibile con le guide dei seguenti marchi, tramite appositi accessori per il fissaggio delle stesse sul telaio: Blum, Grass, Häfele, Hettich. La gamma di accessori proposti da Servetto lascia ampio spazio all'immaginazione: portapantaloni, portabiancheria, portascarpe, ripiani, ecc... si possono creare infinite combinazioni in base alle esigenze del cliente e alla dimensione del vano.

Papillon è disponibile nelle finiture bianco, brown e piombo. Con saliscendi e Papillon nella stessa nuance di colore, si può armonizzare l'interno armadio e scegliere la finitura che meglio si adatta al materiale e colore del proprio ambiente. Design pulito, funzionalità e versatilità. Questo è Papillon.

Papillon und die Servetto-Serie sind für den unteren Bereich des Kleiderschranks gedacht. Die Produktphilosophie sieht einen (ausziehbaren oder festen) Rahmen vor, in dem das Zubehör montiert werden kann, um die gewünschte Zusammensetzung zu konfigurieren. Wie alle Produkte der Servetto-Serie ist Papillon erweiterbar und passt sich den folgenden Abmessungen im Schrankinneren an: cm 77-120, 56-80 und 44-56. Das Papillon-System ist mit den Führungen der folgenden Marken mit Hilfe von speziellen Komponenten für Rahmenbefestigung kompatibel: Blum, Grass, Häfele, Hettich. Die Palette der von Servetto angebotenen Zubehörteile lässt der Fantasie viel Raum: Mit Hilfe von Hosenhalter, Wäschekorb, Schuhablage, Fachboden usw. können unendlich viele Kombinationen erstellt werden, die den Bedürfnissen des Kunden und der Größe des Schrankinneren entsprechen.

Papillon ist in den Ausführungen Weiß, Braun und Anthrazit erhältlich. Mit Kleiderlift und Papillon im gleichen Farbton können Sie den Schrank harmonisch gestalten und die Farben wählen, die am besten zum Material und Farbe des Raumes passen. Schlichtes Design, Funktionalität und Vielseitigkeit; das ist Papillon.

Papillon est la gamme de Servetto dédiée à la partie basse de l'armoire. La philosophie du produit prévoit un cadre (extensible ou fixe) dans lequel loger les accessoires pour configurer la composition souhaitée. Comme tous les produits de la gamme Servetto, Papillon est extensible et s'adapte aux dimensions du compartiment de la manière suivante : 77-120, 56-80 et 44-56 cm. Le système Papillon est compatible avec les guides des marques suivantes, avec des accessoires appropriés pour leur fixation sur le cadre : Blum, Grass, Häfele, Hettich. La gamme d'accessoires proposée par Servetto laisse une grande place à l'imagination : porte-pantalons, porte-linge, porte-chaussures, étagères, etc... On peut créer des combinaisons infinies en fonction des besoins du client et de la taille du compartiment.

Papillon est disponible en finitions blanc, brown et plomb. Avec des penderies relevables de la même couleur, il est possible d'harmoniser l'intérieur de l'armoire et de choisir la finition qui convient le mieux au matériau et à la couleur de votre intérieur. Design épuré, fonctionnalité et polyvalence. C'est ça la gamme Papillon.

Papillon is the new range for the low part of the wardrobe. The range consists of a frame (width adjustable or fixed) to use in combination with a selection of optional accessories offering several storage solutions. Papillon is width adjustable, like all the Servetto products, in order to match the following compartment widths: cm 77-120, cm 56-80 and cm 44-56. The frame Papillon is compatible with the runners Blum, Grass, Häfele and Hettich, by using the adaptors available in the range. Many flexible solutions for organizing the wardrobe compartment based on your needs, by using the complementary accessories: trousers rack, laundry basket, shoe rack, frame for shelf.

Papillon is available in the finishes white, brown and anthracite to match the wardrobe lift in the upper part of the wardrobe. Papillon: minimal design, functionality and flexibility.

Papillon y la gama Servetto que se dedica a la parte inferior del armario. La filosofía del producto prevé un marco (extensible o fijo) en el que introducir los accesorios para que se pueda configurar la composición deseada. Como todos los productos de la gama Servetto, Papillon es extensible y se adapta a las dimensiones del compartimiento de las siguientes maneras: 77-120, 56-80 y 44-56 cm. El sistema Papillon es compatible con las guías de las siguientes marcas, a través de accesorios especiales que permitan fijar estas en el marco: Blum, Grass, Häfele, Hettich. La gama de accesorios propuesta por Servetto deja un amplio espacio a la imaginación: soporte para pantalones, cesta de la ropa, zapatero, etc... se pueden crear muchas combinaciones de acuerdo con las exigencias del cliente y el tamaño del compartimiento.

Papillon está disponible en los acabados blanco, brown y antracita. Con barras de deslizamiento y Papillon del mismo color, se puede armonizar la parte interior del armario y seleccionar el acabado que mejor se adapta al material y color de su entorno. Diseño limpio, funcionalidad y versatilidad. Este es Papillon.



Il sistema Papillon è estremamente facile da montare e intuitivo nell'utilizzo: gli accessori sono semplicemente appoggiati al telaio e sono spostabili e removibili.

Das Papillon-System ist sehr einfach zu montieren und intuitiv zu bedienen: das Zubehör ist einfach in den Rahmen einzusetzen und kann bewegt und abgenommen werden.

Le système Papillon est extrêmement facile à monter et intuitif à utiliser : les accessoires sont simplement appuyés sur le cadre et sont mobiles et amovibles.

The range Papillon is extremely easy to install. The accessories are simply placed on the frame and can be mixed, moved or changed in case you want to reorganize the wardrobe compartment after some time.

El sistema Papillon es muy fácil de montar e intuitivo en su uso: los accesorios resultan sólo apoyados en el marco y, por esta razón, pueden moverse y extraerse.





006
007

Il telaio standard di Papillon è estensibile, in modo da adattarsi alla larghezza dei vani. Se si desidera un telaio ad hoc per le esigenze del cliente, Servetto propone il servizio custom made fornendo il profilo fronte+retro alla misura desiderata. MOQ e LEAD TIME sono variabili e da discutere al momento della richiesta.

Der Standardrahmen von Papillon ist ausziehbar, damit er an die Breite der Fächer angepasst werden kann. Mit dem Service Custom Made, kann dem Bedürfnis des Kunden auf einen Fix-Rahmen nachkommen, in dem das Vorder- und Rückseitenprofil mit der Abmessung bereitgestellt werden kann. Mindestbestellmenge und Lieferfrist sind variabel und werden Angebot mitgeteilt.

La Cadre standard de Papillon est extensible pour s'adapter à la largeur des compartiments. Si une Cadre ad hoc pour les exigences du client, Servetto offre le service sur mesure en fournissant le profil avant + arrière à la dimension souhaitée. MOQ et LEAD TIME sont variables et doivent être discutés au moment de la demande.

The standard Papillon frame is extendable so it can be adjusted to the width of its compartment. If you want an ad hoc frame to meet your customer's needs, Servetto provides a custom-made service, supplying the front+back in the desired size. MOQ and LEAD TIMES are variable and can be discussed when placing the order.

El bastidor estándar de Papillon es extensible para adaptarse a la anchura de los compartimentos. Si se desea un bastidor ad hoc para las necesidades del cliente, Servetto ofrece el servicio personalizado proporcionando el perfil delantero+trasero en la medida deseada. MOQ y LEAD TIME son variables y se deben discutir en el momento de la solicitud.

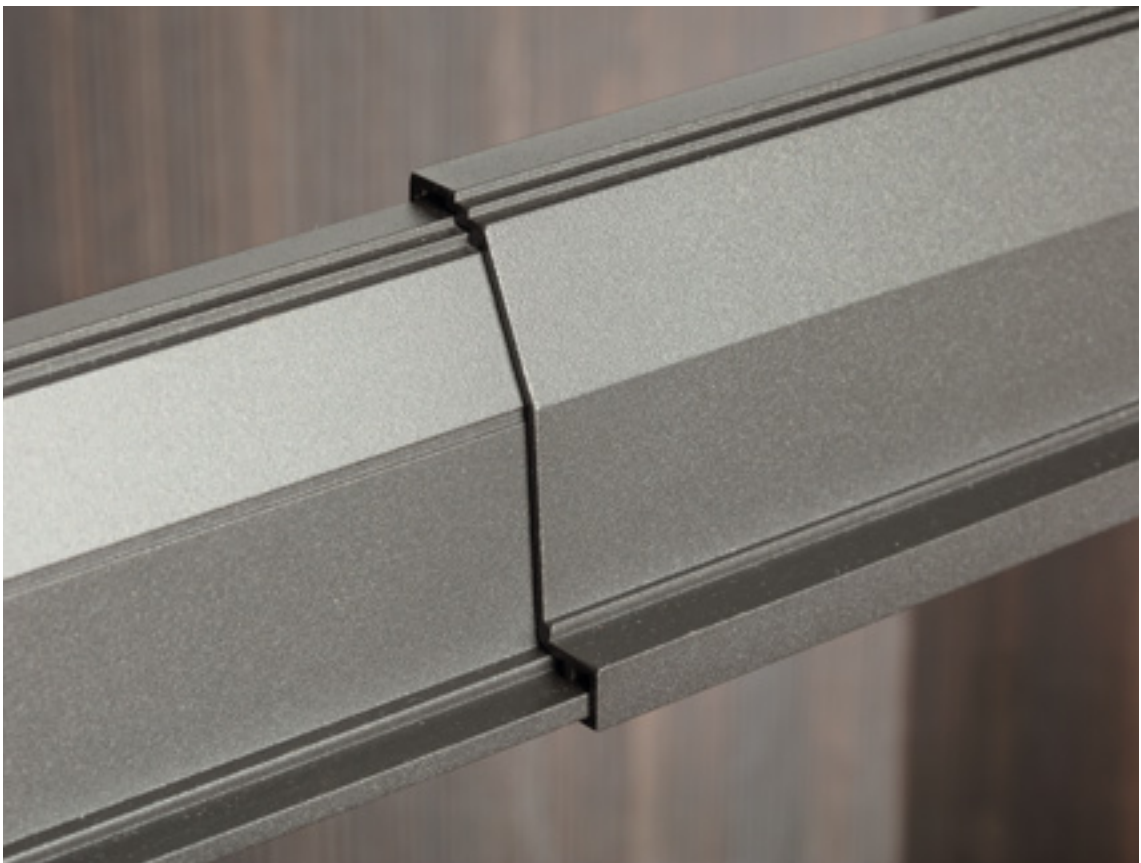



L'articolo è composto da tubetti indipendenti, removibili e spostabili su cui alloggiare i pantaloni. I tubetti sono forniti completi di anelli antiscivolo ed ogni set comprende 4 tubetti.

Der Artikel besteht aus unabhängigen, abnehmbaren und beweglichen Stangen, auf denen die Hose aufgehängt werden kann. Die Stangen werden komplett mit Antirutschringen geliefert und jedes Set beinhaltet 4 Stangen.

L'article se compose de tubes indépendants, amovibles et mobiles pour loger les pantalons. Les tubes sont fournis avec des anneaux antidérapants et chaque set comprend 4 tubes.

The item consists of independent, removable and moveable tubes on which to hang trousers. The tubes come complete with non-slip rings and each set includes 4 tubes.

El artículo está compuesto por tubos independientes, extraíbles y móviles en los que puede acomodar los pantalones. Los tubos se suministran completos con anillos antideslizantes y cada set incluye 4 tubos.



Il cliente può far eseguire la mensola da alloggiare all'interno di Papillon del materiale desiderato.

Der Kunde kann den Einlegeboden, welcher in den Papillon eingebaut werden soll, aus dem gewünschten Material anfertigen lassen.

Le client peut faire réaliser l'étagère à loger à l'intérieur de Papillon du matériau souhaité.

The shelf to insert in Papillon can be of a material of the customer's choosing.

El cliente puede solicitar la realización del estante para colocar dentro de Papillon del material deseado.



012
013



Roomy e l'accessorio della gamma Servetto,
compatibile con il telaio Papillon.

Roomy ist ein Zubehör aus der Serie Servetto und ist
mit dem Rahmen Papillon kompatibel.

Roomy est l'accessoire de la gamme Servetto,
compatible avec la Cadre Papillon.

Roomy box, compatible with the Papillon frame.

El cajón Roomy, compatible con el bastidor Papillon.

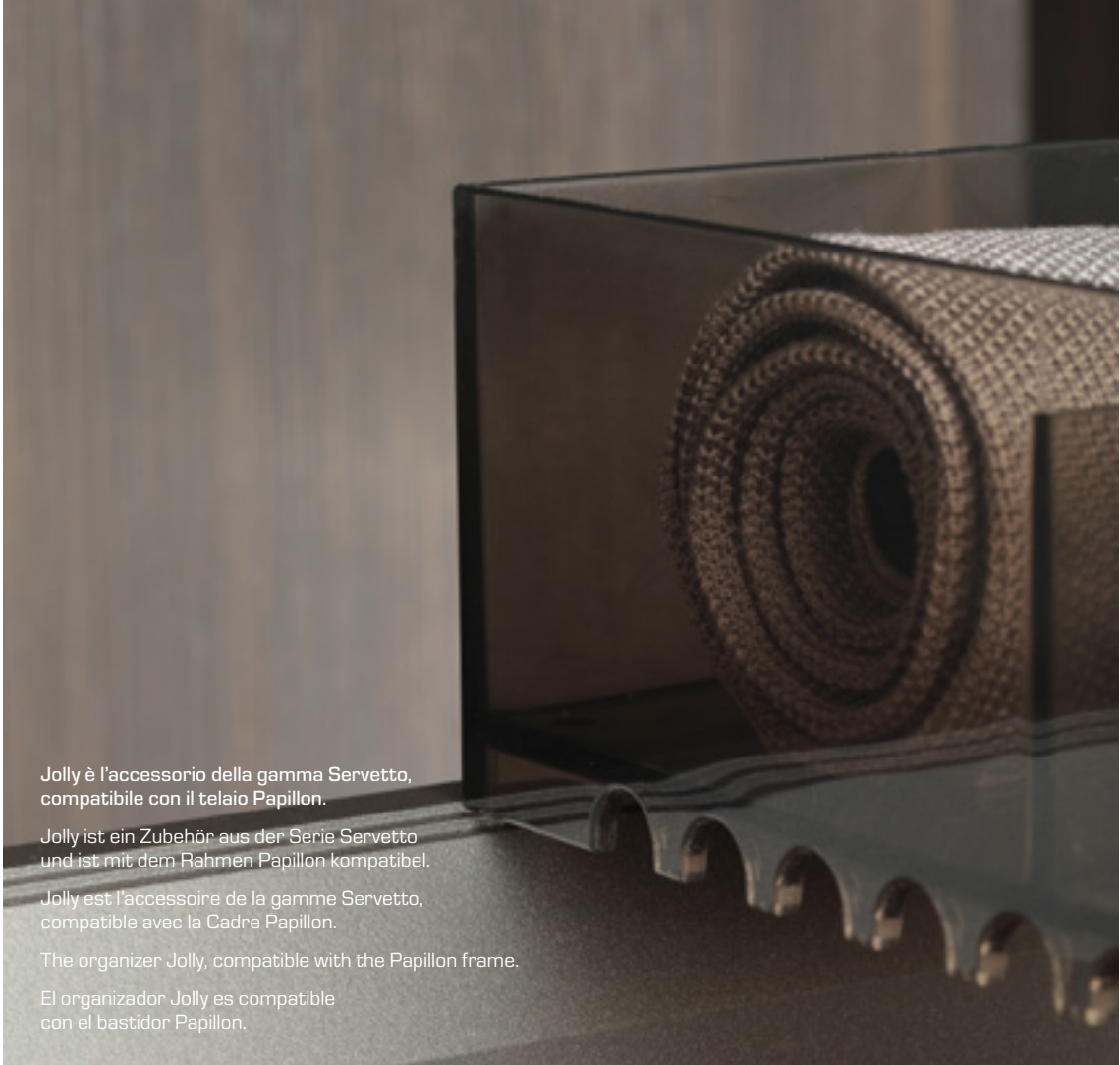

Jolly è l'accessorio della gamma Servetto, compatibile con il telaio Papillon.

Jolly ist ein Zubehör aus der Serie Servetto und ist mit dem Rahmen Papillon kompatibel.

Jolly est l'accessoire de la gamme Servetto, compatible avec la Cadre Papillon.

The organizer Jolly, compatible with the Papillon frame.

El organizador Jolly es compatible con el bastidor Papillon.





L'articolo è composto da n. 1 modulo indipendente, removibile e spostabile in cui riporre la biancheria.

Der Artikel besteht aus einem unabhängigen, abnehmbaren und beweglichen Modul, in das die Wäsche abgelegt werden kann.

L'article se compose de n°1 module indépendant, amovible et mobile pour ranger le linge.

The item consists of no. 1 independent, removable and moveable module in which to gather laundry.

El artículo está compuesto por n.º 1 módulo independiente, extraíble y móvil en el que se puede acomodar la ropa.



La sponda frontale del telaio estensibile è divisa in tre parti, non tutte alla stessa quota. Per risolvere lo scompenso, si può utilizzare l'accessorio compensatore per avere tutto alla stessa quota di appoggio.

Die Vorderleiste des ausziehbaren Rahmens ist in drei ungleichmäßige Teile unterteilt. Um die Ungleichmäßigkeit zu beheben, kann der Kompensator verwendet werden, um alles auf die gleiche Höhe zu bringen.

Le bord avant de la Cadre extensible est divisé en trois parties, pas toutes à la même cote. Pour résoudre le déséquilibre, on peut utiliser l'accessoire compensateur pour tout avoir à la même cote d'appui.

The front side of the extendable frame is divided into three parts which are not all at the same height. To level them off you can use the compensator to bring them into line.

El lado frontal del bastidor extensible está dividido en tres partes, no todas a la misma distancia. Para resolver la descensación, puede utilizar el accesorio compensador para tener todo en la misma altura de apoyo.



Lo spessore delle cerniere e/o delle ante può ostacolare lo scorrimento del prodotto. In questo caso si consiglia l'installazione con uno o due distanziatori modulari.

Scharniere und/oder Türen können die Leichtgängigkeit des Produktes beeinträchtigen. In diesem Fall empfiehlt sich der Einbau mit einem oder zwei modularen Distanzstücken.

L'épaisseur des charnières et/ou des portes peut empêcher le glissement du produit. Dans ce cas on conseille l'application de cales.

The thickness of the hinges and/or the doors can prevent the sliding of the product. In this case, we recommend the installation with one or two modular spacers.

El espesor de las bisagras y/o de las puertas puede obstaculizar el movimiento de los accesorios extraíbles. En este caso, aconsejamos la instalación con uno o dos separadores modulares.

Portascarpe di Papillon è composto da moduli in policarbonato indipendenti, removibili e spostabili su cui alloggiare le scarpe. Possono essere affiancati e collegati tra loro in modo da raggiungere la larghezza vano desiderata e il profilo permette di alloggiare le scarpe su due livelli e in svariate posizioni. Ogni set comprende 2 elementi e il connettore.

Die Schuhablage von Papillon besteht aus Modulen (Polycarbonat) welche unabhängigen, abnehmbaren und beweglichen sind, auf denen die Schuhe abgelegt werden können. Sie können nebeneinander gestellt und miteinander verbunden werden, um die gewünschte Fächerbreite zu erreichen, und das Profil erlaubt es, die Schuhe auf zwei Ebenen und in verschiedenen Positionen zu platzieren. Jedes Set enthält zwei Elemente und den Verbinder.

Le porte-chaussures du Papillon se compose de modules en polycarbonate indépendants, amovibles et mobiles pour ranger les chaussures. Ils peuvent être placés côte à côte et reliés entre eux de manière à atteindre la largeur du compartiment souhaitée et le profil permet de loger les chaussures sur deux niveaux et en différentes positions. Chaque kit comprend 2 éléments et le connecteur.

The Papillon shoe rack consists of independent polycarbonate removable and moveable modules on which to store shoes. They can be placed side by side and connected to achieve the desired compartment width and their design allows you to store the shoes on two levels and in various positions. Each set includes 2 elements and a connector.

El zapatero Papillon está formado por módulos de policarbonato independientes, extraíbles y móviles en los que colocar sus zapatos. Pueden colocarse uno al lado del otro y combinarse los unos con los otros para alcanzar la anchura deseada del compartimiento y el perfil permite colocar los zapatos sobre dos niveles y en diferentes posiciones. Cada conjunto incluye 2 elementos y el conector.





016
017



BROWN – BROWN
brown-brown

018
019



BIANCO – BIANCO
white-white



SCHEDA TECNICHE

TECHNICAL DATA

PAPILLON

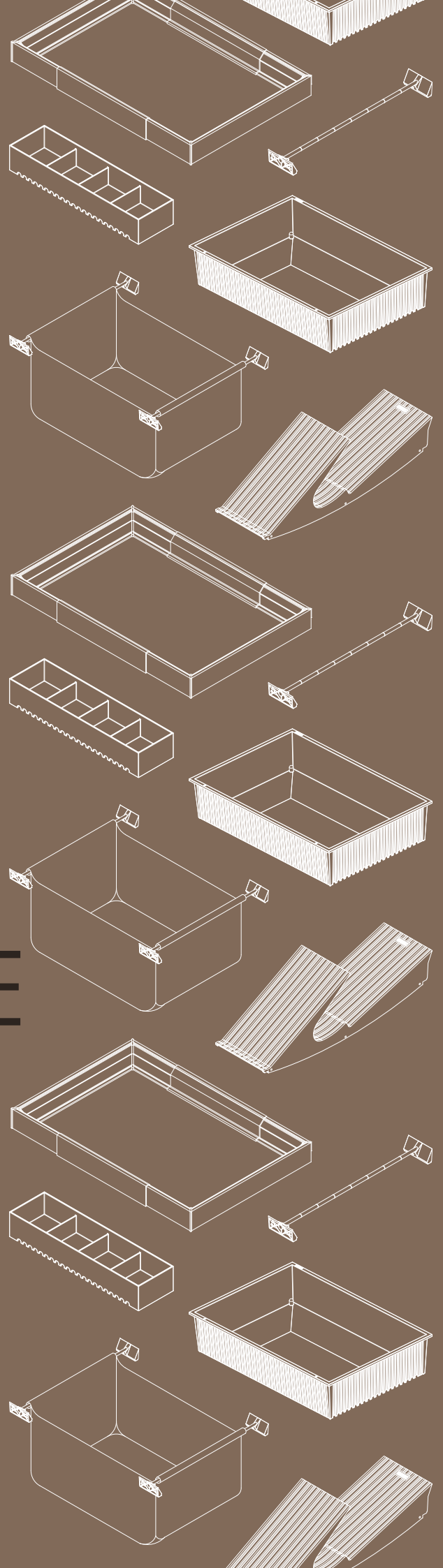

PAPILLON (PER GUIDA | RUNNER HETTICH)

Telaio estensibile | Adjustable frame

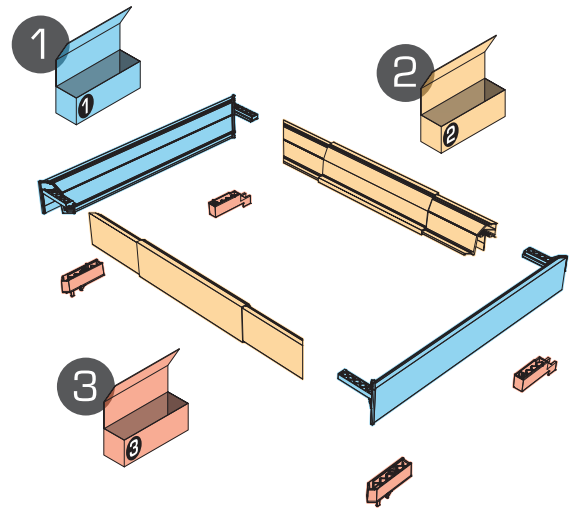
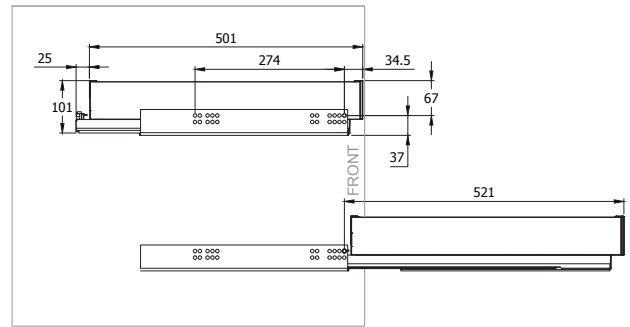
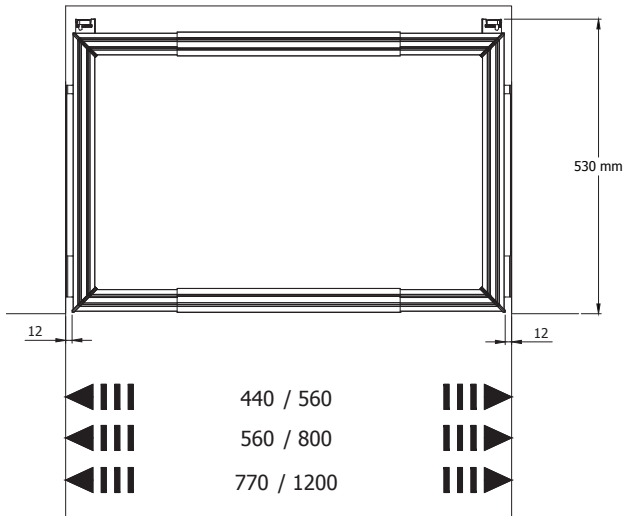

1

SPONDINE LATERALI DX+SX
pull out lateral sides

BIANCO
white

PA1S00400

BROWN
brown

PA1S00B00

PIOMBO
anthracite

PA1S00P00

2

FRONTE + RETRO
PER TELAIO ESTENSIBILE
width adjustable front + rear

BIANCO
white

PA2FLA400 cm 77-120

PA2FME400 cm 56 - 80

PA2FSM400 cm 44 - 56

BROWN
brown

PA2FLAB00 cm 77-120

PA2FMEB00 cm 56 - 80

PA2FSMB00 cm 44 - 56

PIOMBO
anthracite

PA2FLAP00 cm 77-120

PA2FMEP00 cm 56 - 80

PA2FSMP00 cm 44 - 56

3

ADATTATORE GUIDA HETTICH
adaptor runner

PA3AHE400 BIANCO /white

PA3AHEB00 BROWN /brown

PA3AHEP00 PIOMBO /anthracite

PAPILLON (PER GUIDA | RUNNER BLUM)

Telaio estensibile | Adjustable frame

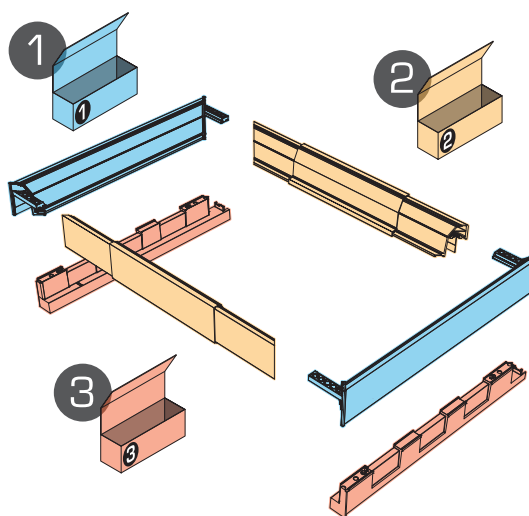
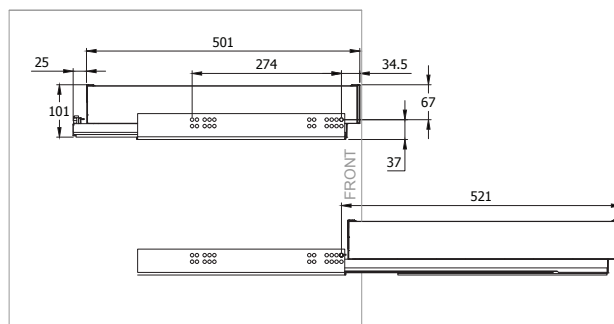
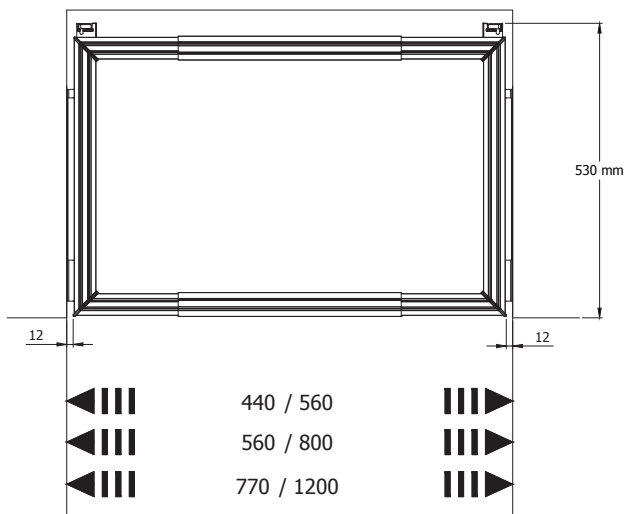

1

SPONDINE LATERALI DX+SX
pull out lateral sides

BIANCO
white

PA1S00400

BROWN
brown

PA1S00B00

PIOMBO
anthracite

PA1S00P00

2

FRONTE + RETRO
PER TELAIO ESTENSIBILE
width adjustable front + rear

BIANCO
white

PA2FLA400 cm 77-120

PA2FME400 cm 56 - 80

PA2FSM400 cm 44 - 56

BROWN
brown

PA2FLAB00 cm 77-120

PA2FMEB00 cm 56 - 80

PA2FSMB00 cm 44 - 56

PIOMBO
anthracite

PA2FLAP00 cm 77-120

PA2FMEP00 cm 56 - 80

PA2FSMP00 cm 44 - 56

3

ADATTATORE GUIDA BLUM
adaptor runner

PA3ABL400 BIANCO /white

PA3ABL00 BROWN /brown

PA3ABLP00 PIOMBO /anthracite

PAPILLON (PER GUIDA | RUNNER HÄFELE)

Telaio estensibile | Adjustable frame

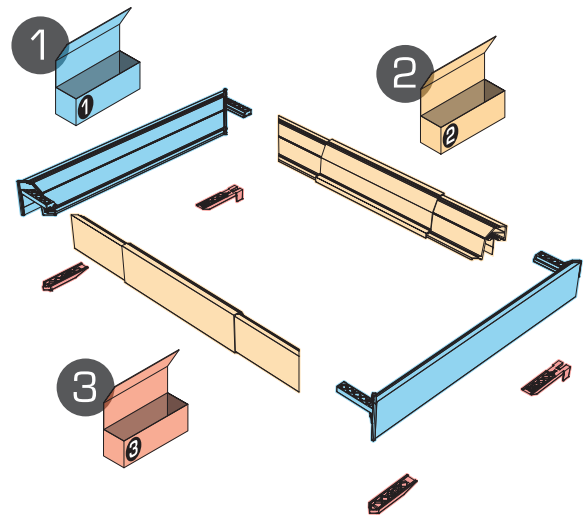
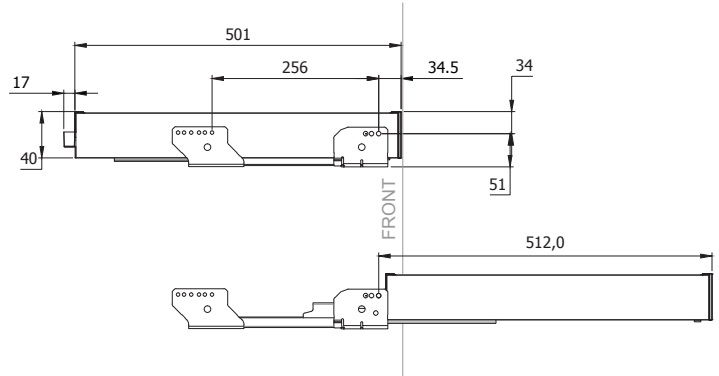
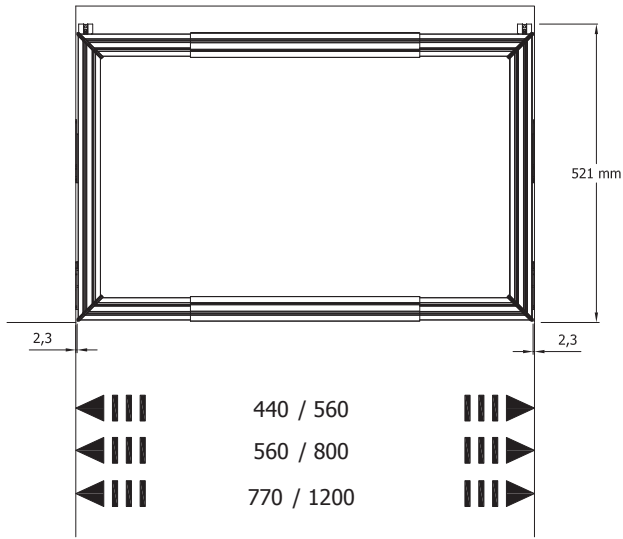

1

SPONDINE LATERALI DX+SX
pull out lateral sides

BIANCO
white

PA1S00400

BROWN
brown

PA1S00B00

PIOMBO
anthracite

PA1S00P00

2

FRONTE + RETRO
PER TELAIO ESTENSIBILE
width adjustable front + rear

BIANCO
white

PA2FLA400 cm 77-120

PA2FME400 cm 56 - 80

PA2FSM400 cm 44 - 56

BROWN
brown

PA2FLAB00 cm 77-120

PA2FMEB00 cm 56 - 80

PA2FSMB00 cm 44 - 56

PIOMBO
anthracite

PA2FLAP00 cm 77-120

PA2FMEP00 cm 56 - 80

PA2FSMP00 cm 44 - 56

3

ADATTATORE GUIDA HÄFELE*
adaptor runner

PA3AHA500 NERO/black

* Parte non visibile

* Part not visible

PAPILLON (PER GUIDA | RUNNER GRASS)

Telaio estensibile | Adjustable frame

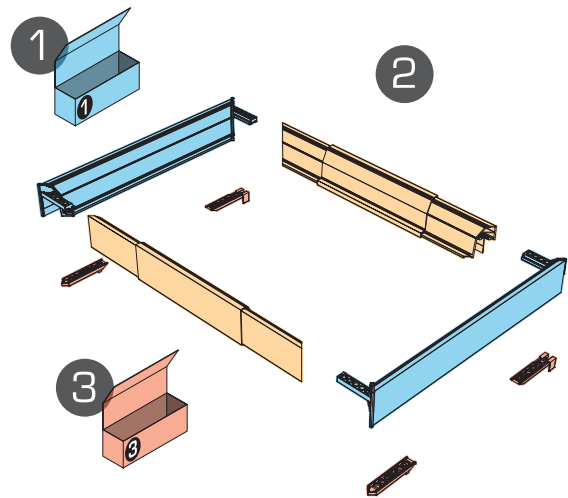
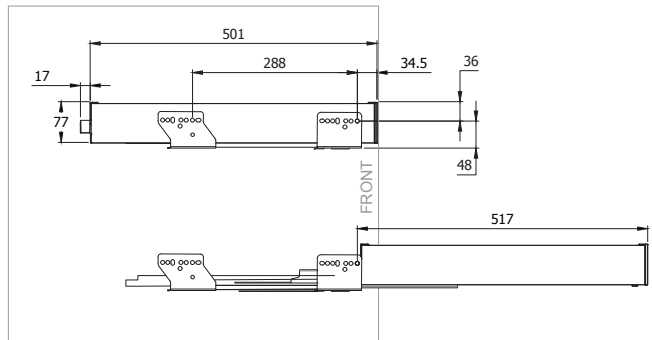
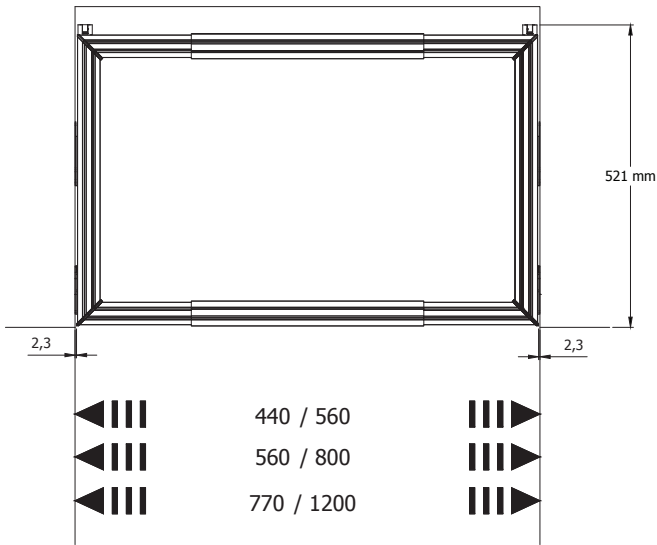

1

SPONDINE LATERALI DX+SX
pull out lateral sides

BIANCO
white

PA1S00400

BROWN
brown

PA1S00B00

PIOMBO
anthracite

PA1S00P00

2

FRONTE + RETRO
PER TELAIO ESTENSIBILE
width adjustable front + rear

BIANCO
white

PA2FLA400 cm 77-120

PA2FME400 cm 56 - 80

PA2FSM400 cm 44 - 56

BROWN
brown

PA2FLAB00 cm 77-120

PA2FMEB00 cm 56 - 80

PA2FSMB00 cm 44 - 56

PIOMBO
anthracite

PA2FLAP00 cm 77-120

PA2FMEP00 cm 56 - 80

PA2FSMP00 cm 44 - 56

3

ADATTATORE GUIDA GRASS
adaptor runner

PA3AGR500 NERO/black

* Parte non visibile

* Part not visible

PAPILLON (PER GUIDA | RUNNER HETTICH)

Coppia di distanziali | Pair of spacers

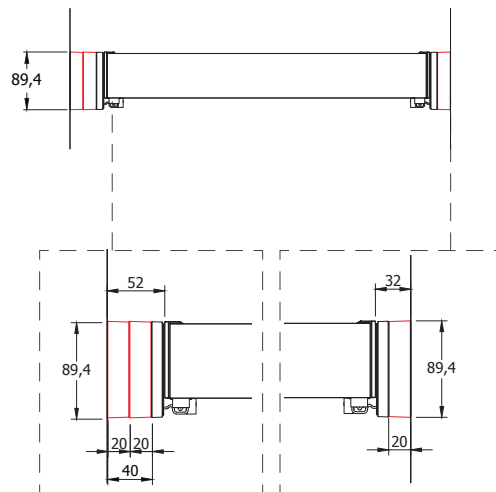
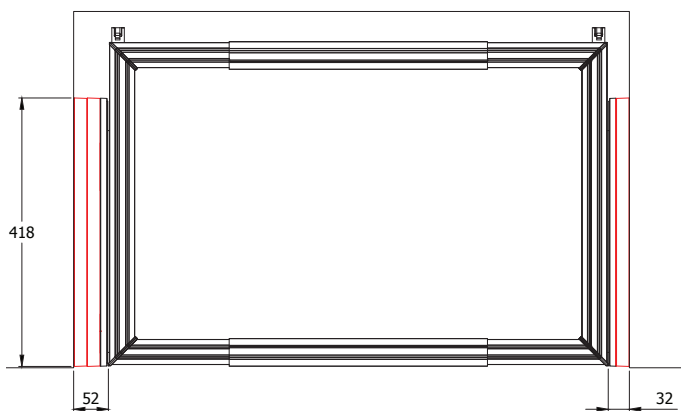

BIANCO
white

PA7D00400

BROWN
brown

PA7D00B00

PIOMBO
anthracite

PA7D00P00

T
026

PAPILLON (PER GUIDA | RUNNER BLUM)

Coppia di distanziali | Pair of spacers

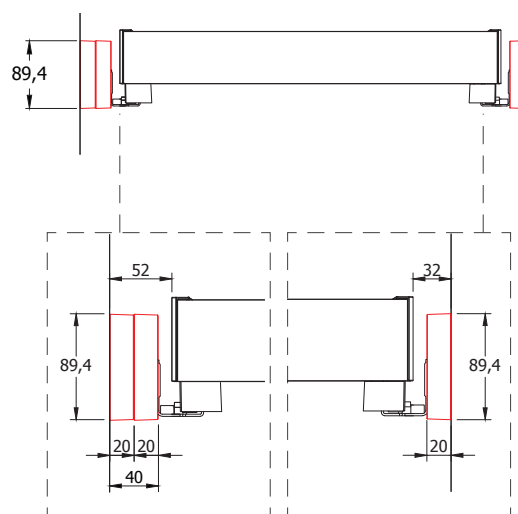
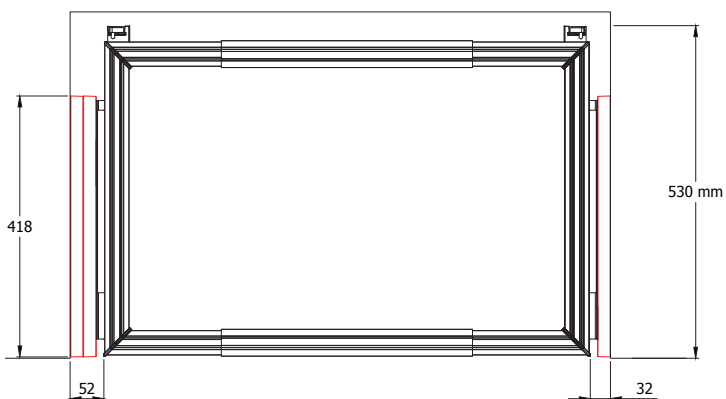

BIANCO
white

PA7D00400

BROWN
brown

PA7D00B00

PIOMBO
anthracite

PA7D00P00

PAPILLON (PER GUIDA | RUNNER HÄFELE)

Coppia di distanziali | Pair of spacers

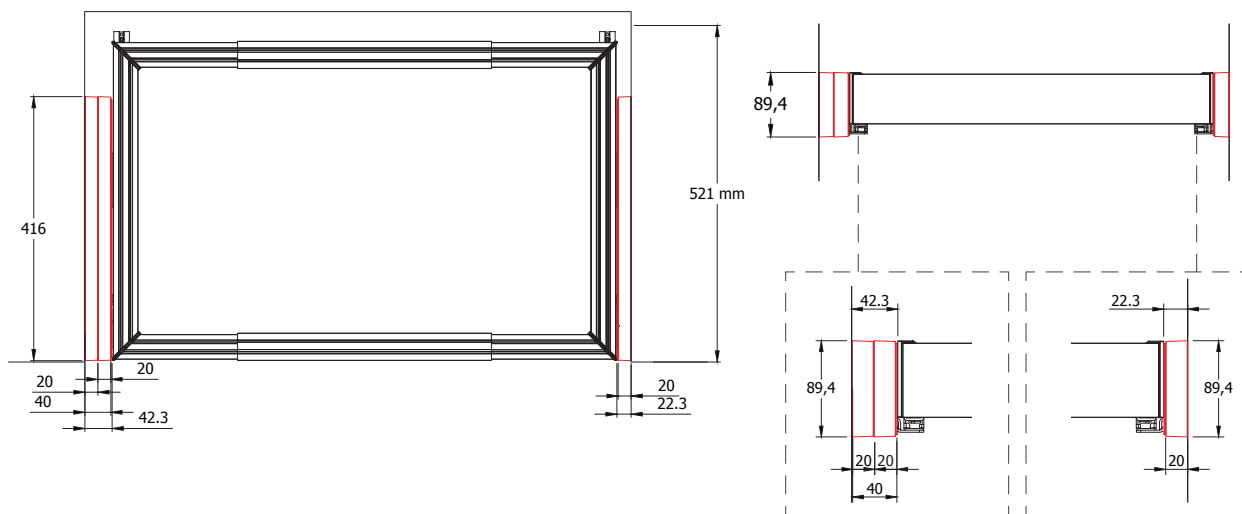

BIANCO
white

PA7D00400

BROWN
brown

PA7D00B00

PIOMBO
anthracite

PA7D00P00

T
027

PAPILLON (PER GUIDA | RUNNER GRASS)

Coppia di distanziali | Pair of spacers

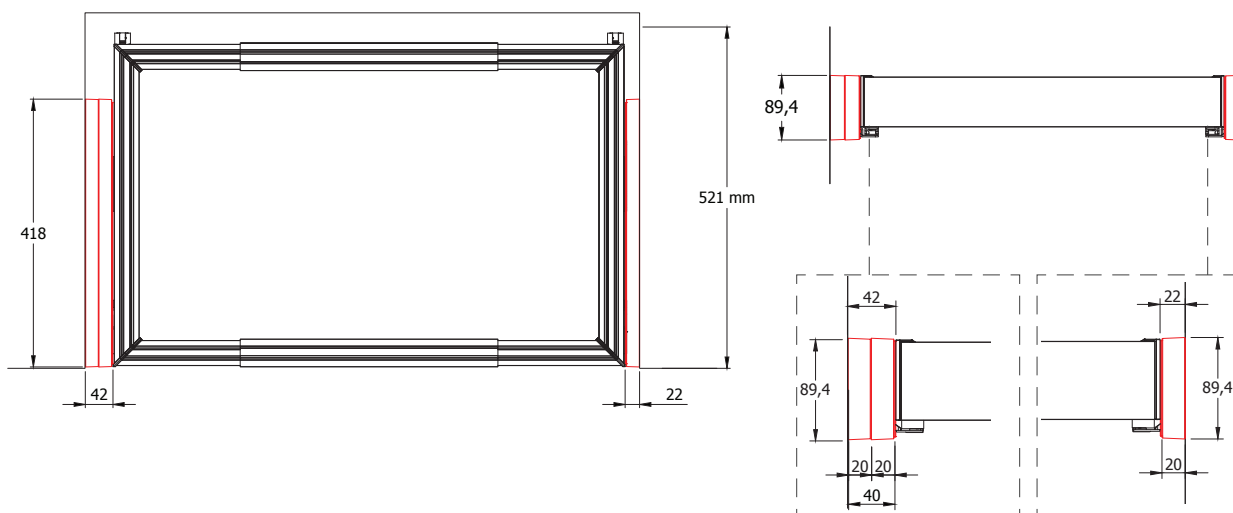

BIANCO
white

PA7D00400

BROWN
brown

PA7D00B00

PIOMBO
anthracite

PA7D00P00

PAPILLON

Set 4 tubetti portapantaloni | Set of 4 tubes for trousers rack

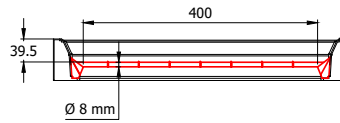
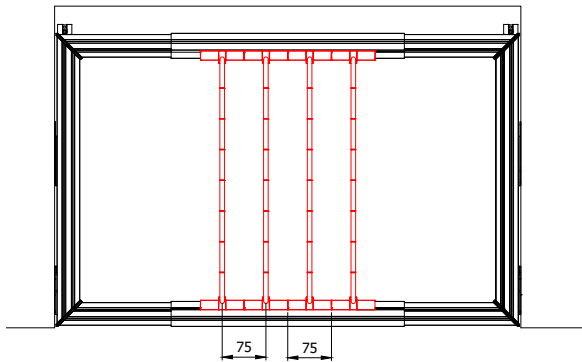

BIANCO
white

PA4P00400

BROWN
brown

PA4P00B00

PIOMBO
anthracite

PA4P00P00

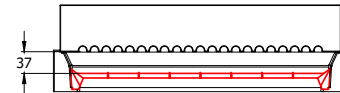

PAPILLON

Set 2 vaschette portascarpe | Set of 2 trays for shoe rack

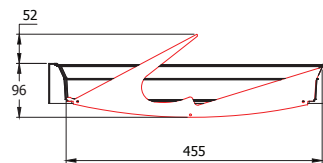
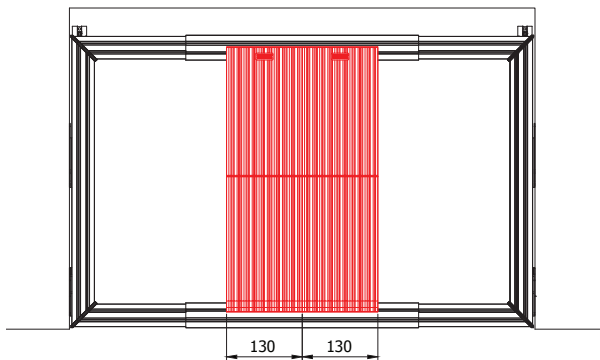

TRASPARENTE
transparent

PA5S00T00

BROWN FUME'
brown fumè

PA5S00BF0

PIOMBO FUMÈ
anthracite fumè

PA5S00PF0

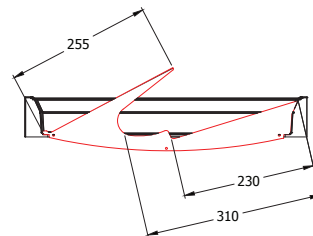

PAPILLON

Set portabiancheria | Set of laundry basket

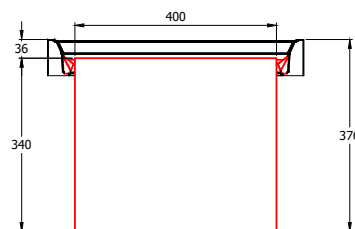
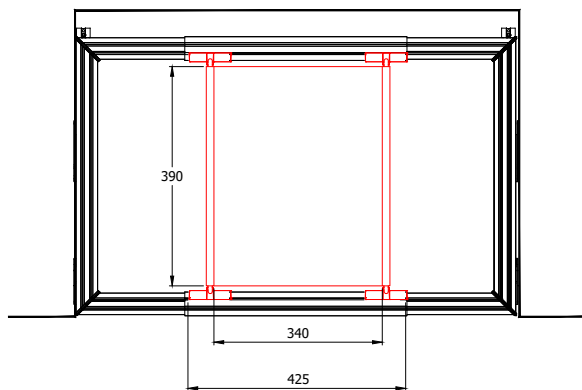

BIANCO
white

PA6B00400

BROWN
brown

PA6B00B00

PIOMBO
anthracite

PA6B00P00

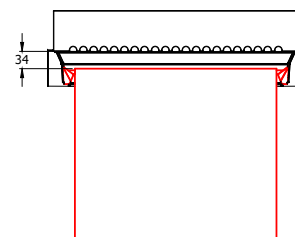

PAPILLON

DISEGNO TECNICO RIPIANO (non incluso) | TECHNICAL DESIGN SHELF (not included)

HETTICH

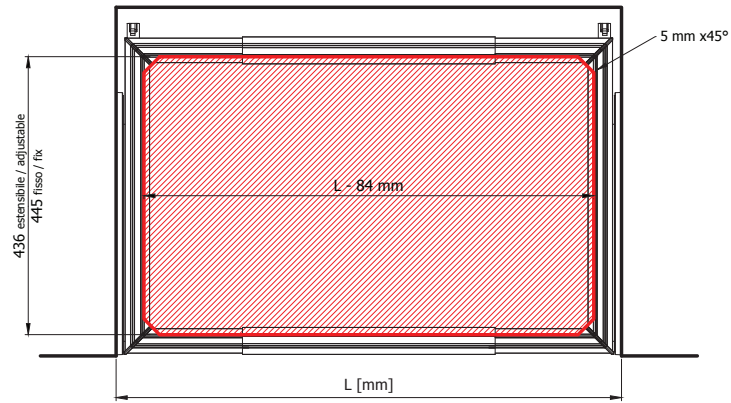

BLUM

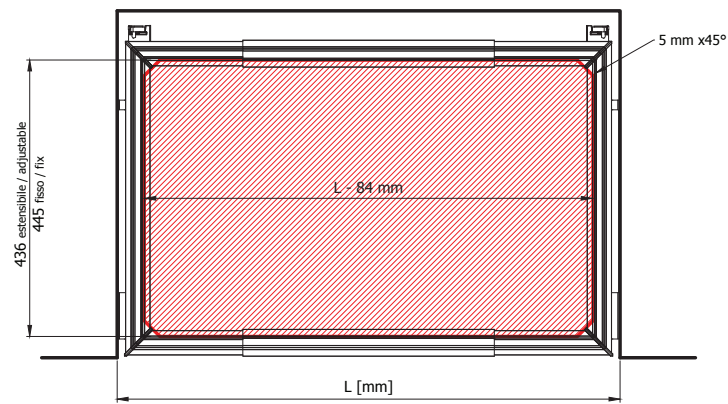

HÄFELE

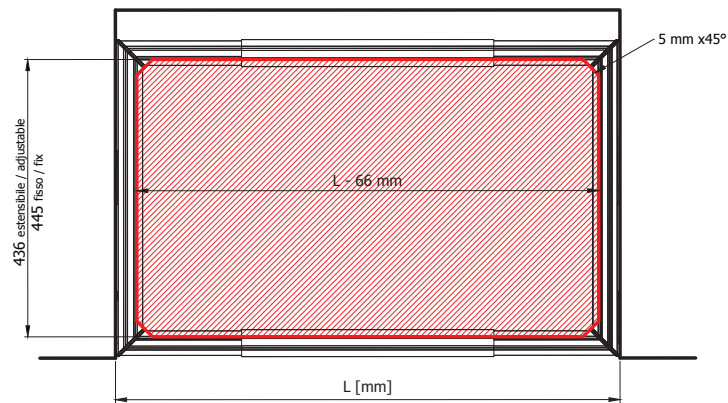

GRASS

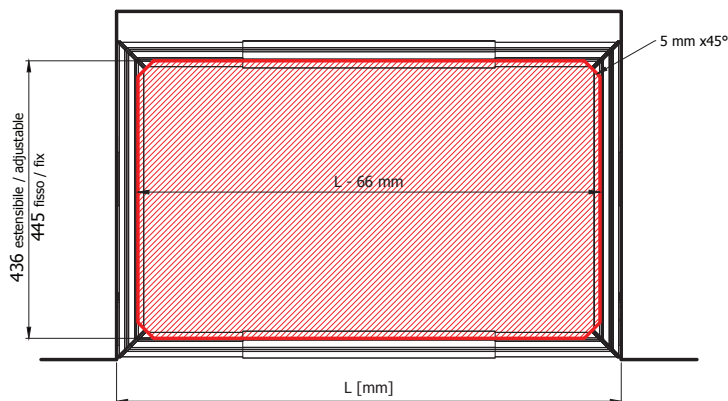

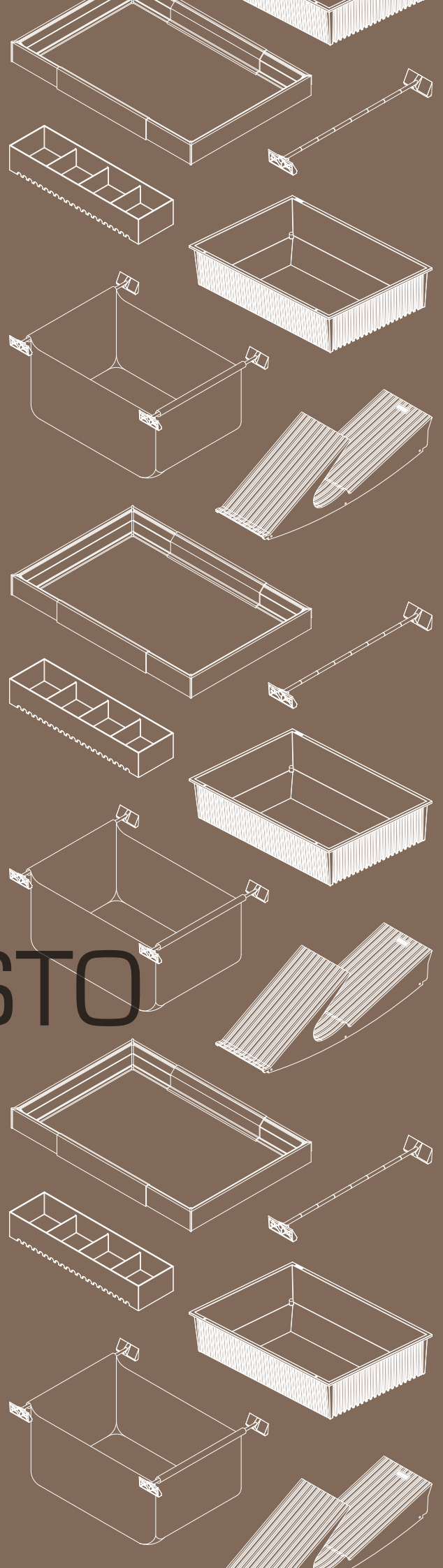

GUIDA ALL'ACQUISTO

BUYING GUIDE

PAPILLON

Il prodotto PAPILLON si compone come segue:
PAPILLON is supplied as follows:

A Telaio | Frame

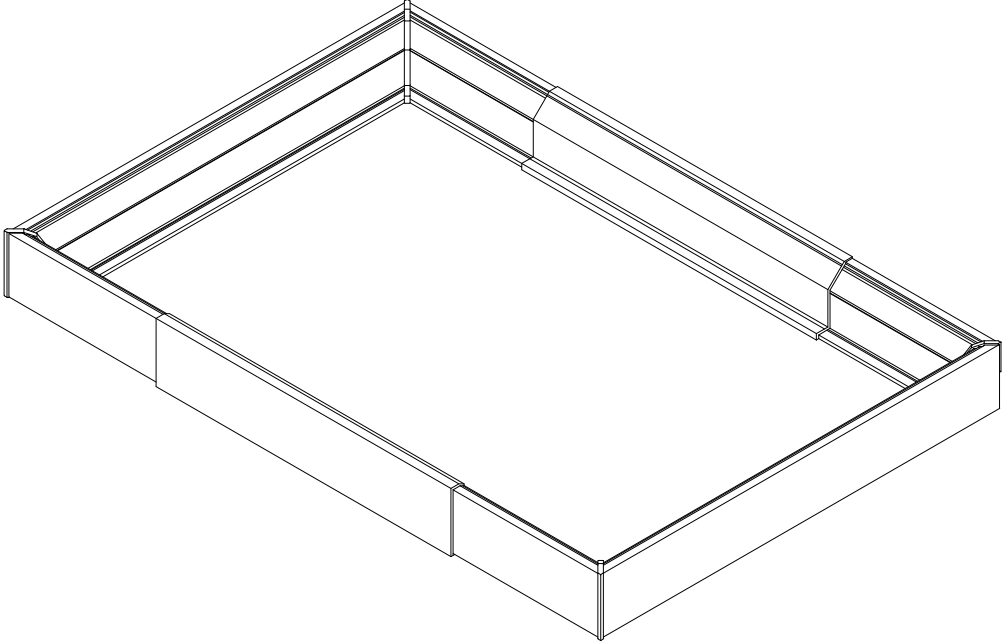

B Accessori | Complementary accessories

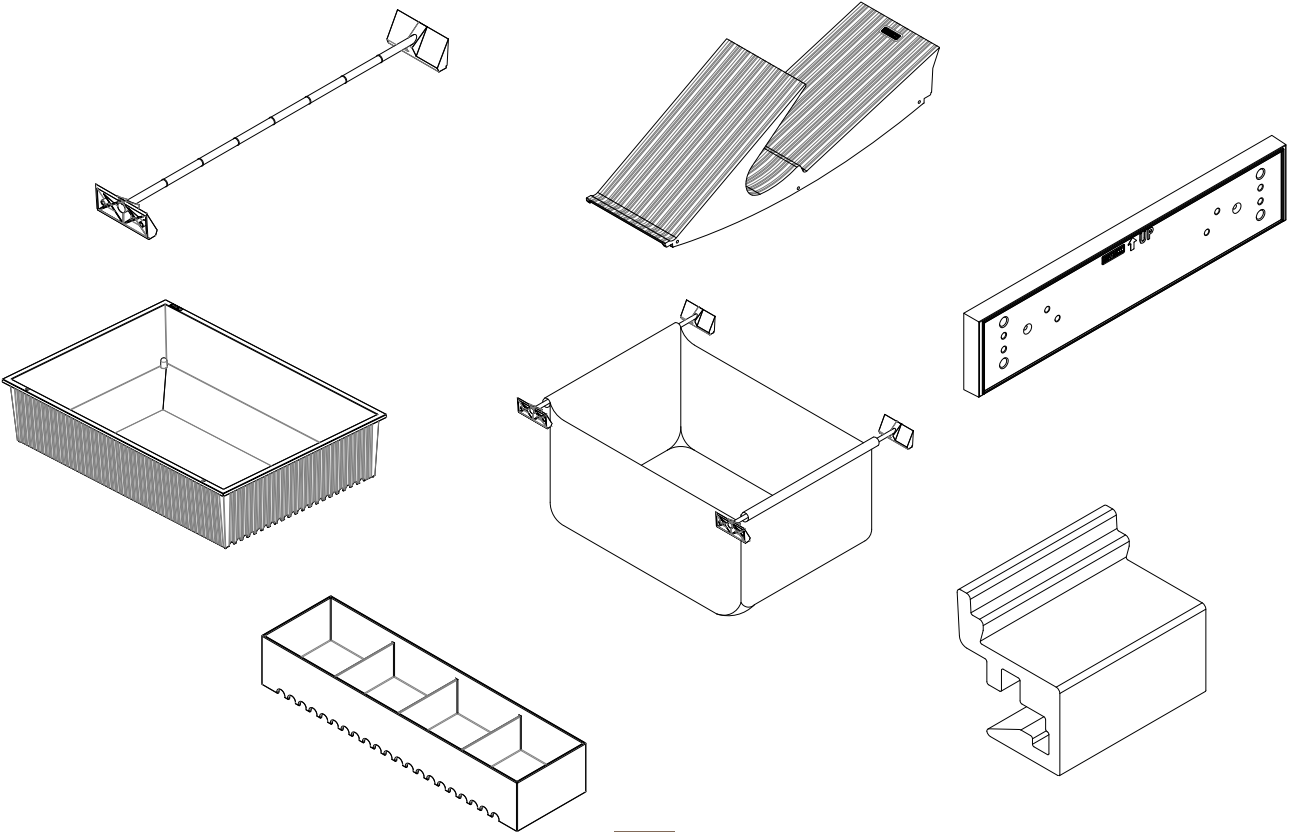

A Telaio estensibile | Width adjustable frame

Il telaio è la base che può essere combinata con gli accessori
The frame is the base and can be combined with the accessories

B

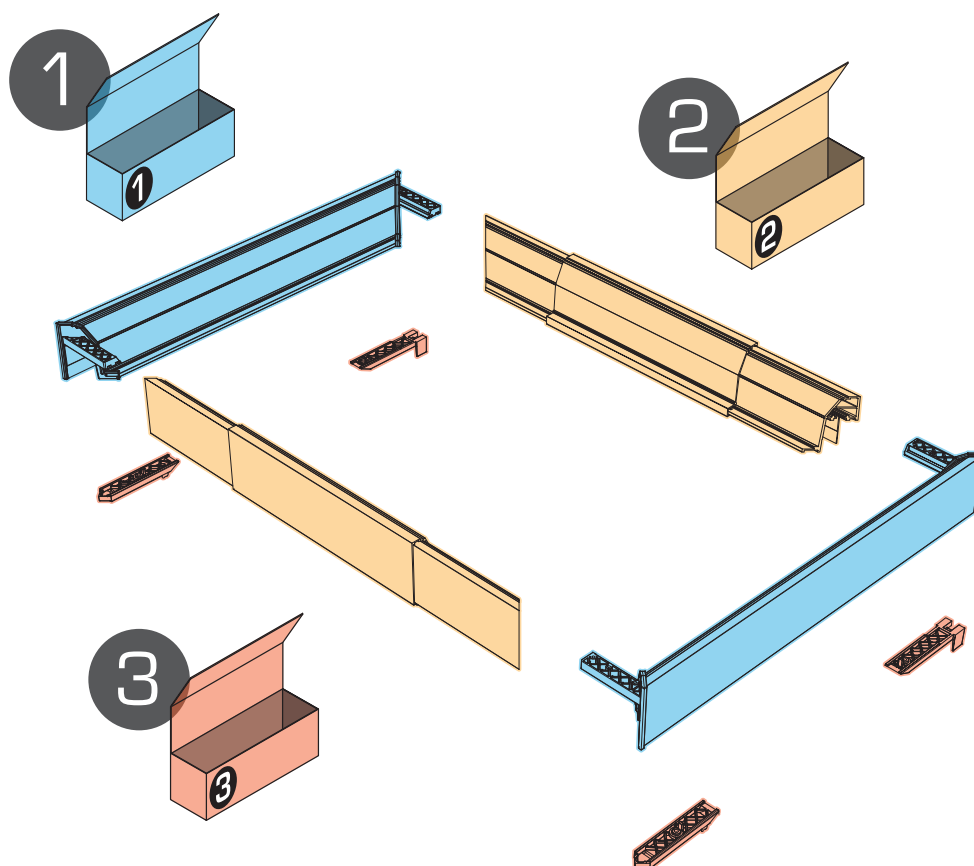

Il telaio di Papillon si compone come segue:

CONFEZIONE 1: spondine laterali dx+sx
sulle spondine verranno applicati gli adattatori
(confezione 3) per l'installazione della guida che più si
adatta alle esigenze del cliente

CONFEZIONE 2: fronte+retro per telaio estensibile
il telaio è estensibile per adattarsi alle diverse
dimensioni dei vani

CONFEZIONE 3: adattatori guide
Compatibilità con i seguenti tipi di guide:

The Papillon frame is supplied as follows:

PACK 1: right+left sides
the adapters (pack 3) will be applied to the sides for
the installation of the runner that best meets the
customer's requirements

PACK 2: front+back for width adjustable frame
the frame can be adjusted in order to adapt it to the
different dimensions of the wardrobe compartment

PACK 3: runner adapters
Compatibility with the following types of runners:

| Marca Brand | Modello Model | Portata Load | Misura Size |
|-------------------|-------------------------------|----------------|---------------|
| Hafele Häfele | Guida Matrix Matrix runner | 35 Kg | 500 mm |
| Hettich Hettich | Quadro V6 Sylent System EB 20 | 30 kg | 500 mm |
| Grass Grass | Nova Pro Soft Close S16/S19 | 40 kg | 500 mm |
| Blum Blum | Tandem | 30 kg | 500 mm |

A Telaio fisso | Fixed frame

Il telaio standard di Papillon è estensibile, in modo da adattarsi alla larghezza dei vani.

Se si desidera un telaio ad hoc per le esigenze del cliente, Servetto propone il servizio custom made fornendo il profilo fronte+retro (confezione 2) alla misura desiderata.

MOQ e LEAD TIME sono variabili e da discutere al momento della richiesta.

The standard Papillon frame is extendable so it can be adjusted to the width of its compartment.

If you want an ad hoc frame to meet your customer's needs, Servetto provides a custom-made service, supplying the front+back (pack 2) in the desired size.

MOQ and LEAD TIMES are variable and can be discussed when placing the order.

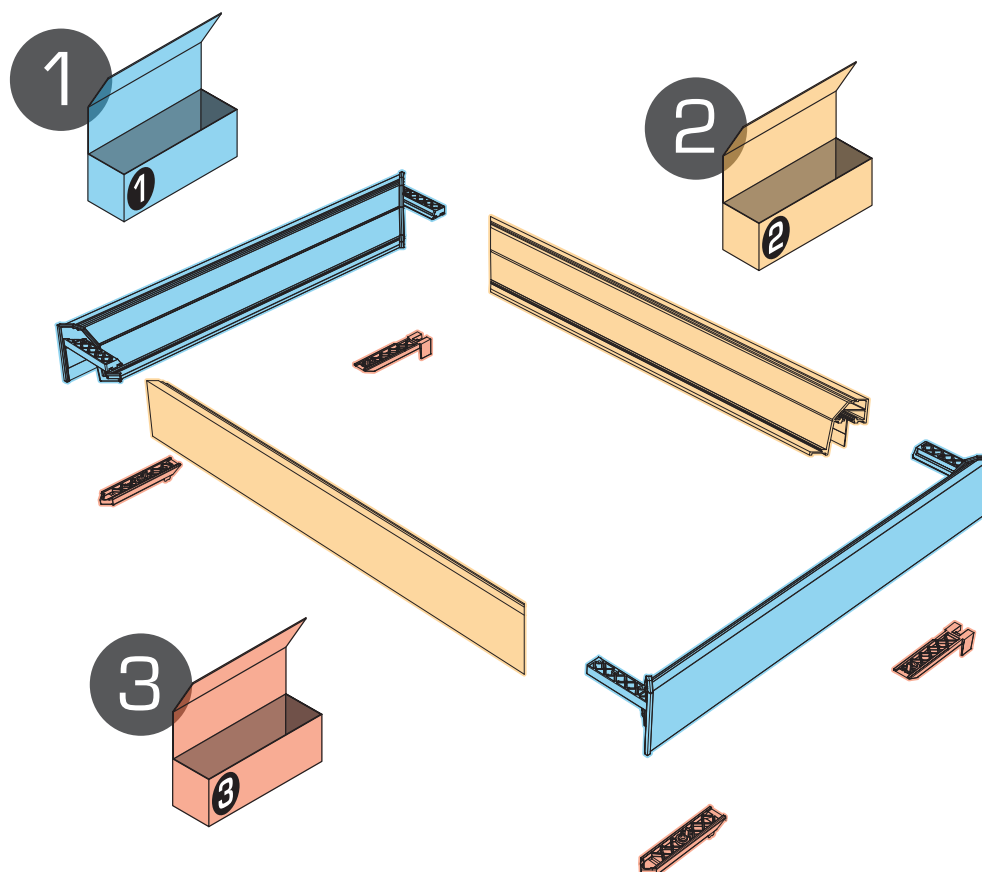

Il telaio di Papillon nella versione FISSA si compone come segue:

CONFEZIONE 1 : spondine laterali dx+sx

CONFEZIONE 2 : fronte+retro per telaio fisso

CONFEZIONE 3 : adattatori guide



The FIXED version of the Papillon frame is supplied as follows:

PACK 1: right+left sides

PACK 2: front+back for fixed frame

PACK 3: runner adapters

1. Spondine laterali dx + sx | Right and left sides

| Packaging | Finitura Finish | | Articolo Item |
|-----------|---------------------|---|-----------------|
| 1 Set | Bianco White |  | PA1S00400 |
| 1 Set | Brown Brown |  | PA1S00B00 |
| 1 Set | Piombo Anthracite |  | PA1S00P00 |

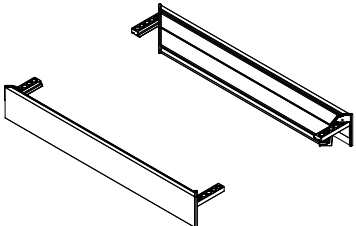









* 1 set = sponda destra e sponda sinistra

* 1 set = right side and left side

** Per maggiori dettagli, vedi scheda tecnica.

** For more details, see data sheet

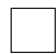
2. Fronte + retro per telaio estensibile | Front + back for adjustable frame

| Misura Size | Packaging | Finitura Finish | | Articolo Item |
|---------------------------|-----------|---------------------|---|-----------------|
| LARGE 770 - 1200 mm | 1 Set | Bianco White |  | PA2FLA400 |
| | 1 Set | Brown Brown |  | PA2FLAB00 |
| | 1 Set | Piombo Anthracite |  | PA2FLAP00 |
| MEDIUM 560 - 800 mm | 1 Set | Bianco White |  | PA2FME400 |
| | 1 Set | Brown Brown |  | PA2FMEB00 |
| | 1 Set | Piombo Anthracite |  | PA2FMEP00 |
| SMALL 440 - 560 mm | 1 Set | Bianco White |  | PA2FSM400 |
| | 1 Set | Brown Brown |  | PA2FSMB00 |
| | 1 Set | Piombo Anthracite |  | PA2FSMP00 |

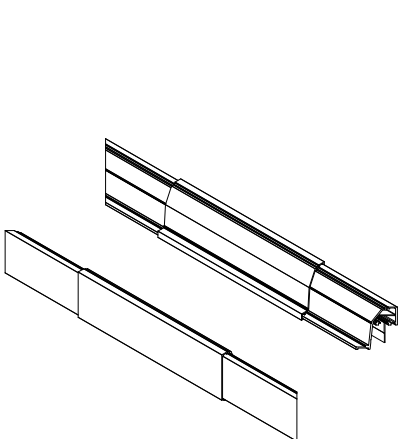

* 1 set = sponda anteriore e sponda posteriore

* 1 set = front side and back side









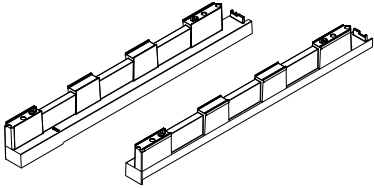

** Nel set sono compresi n.4 compensatori in colore trasparente (vedi pag. 45)

** The set includes no. 4 transparent compensators (see page 45)

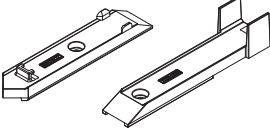
*** Per maggiori dettagli, vedi scheda tecnica

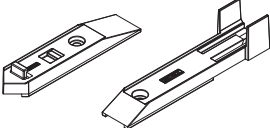
*** For more details, see data sheet

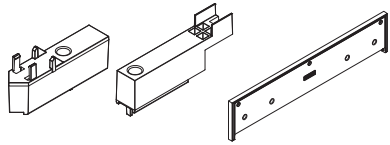
3. Adattatori guide | Runner adapters

| Tipo di guida Runner type | Packaging | Finitura Finish | Articolo Item | | |
|------------------------------|-----------|---|---|-----------|--|
| BLUM | 1 Set | Bianco White |  | PA3ABL400 |  |
| | 1 Set | Brown Brown |  | PA3ABLB00 | |
| | 1 Set | Piombo Anthracite |  | PA3ABLP00 | |
| GRASS | 1 Set | Nero (Parte non visibile) Black (Part not visible) |  | PA3AGR500 |  |
| HÄFELE | 1 Set | Nero (Parte non visibile) Black (Part not visible) |  | PA3AHA500 |  |
| HETTICH | 1 Set | Bianco White |  | PA3AHE400 |  |
| | 1 Set | Brown Brown |  | PA3AHEB00 | |
| | 1 Set | Piombo Anthracite |  | PA3AHEP00 | |

* 1 set = tutti gli elementi necessari per n.1 telaio

* 1 set = all necessary elements for no. 1 frame

B Accessori | Accessories

Il telaio Papillon può essere attrezzato liberamente con i seguenti accessori:
The Papillon frame can be equipped with the following accessories as desired:

1. Portapantaloni | Trouser rack
2. Portascarpe | Shoe rack
3. Portabiancheria | Laundry basket
4. Roomy | Roomy box
5. Jolly | Jolly organizer
6. Distanziale | Spacer
7. Compensatore | Compensator

Gli accessori sono venduti a set e sono combinabili tra loro.
The accessories are supplied in sets and can be combined with each other.

Per calcolare quanti set sono necessari, proponiamo una tabella per ciascun prodotto.
To calculate how many sets are needed, below is a table for each product.

La formula generica è la seguente:
The general formula is as follows:

Larghezza Telaio Utilizzabile (Lu) = Larghezza Vano (L) - 120mm
Usable Frame Width (Lu) = Width Compartment (L) - 120 mm

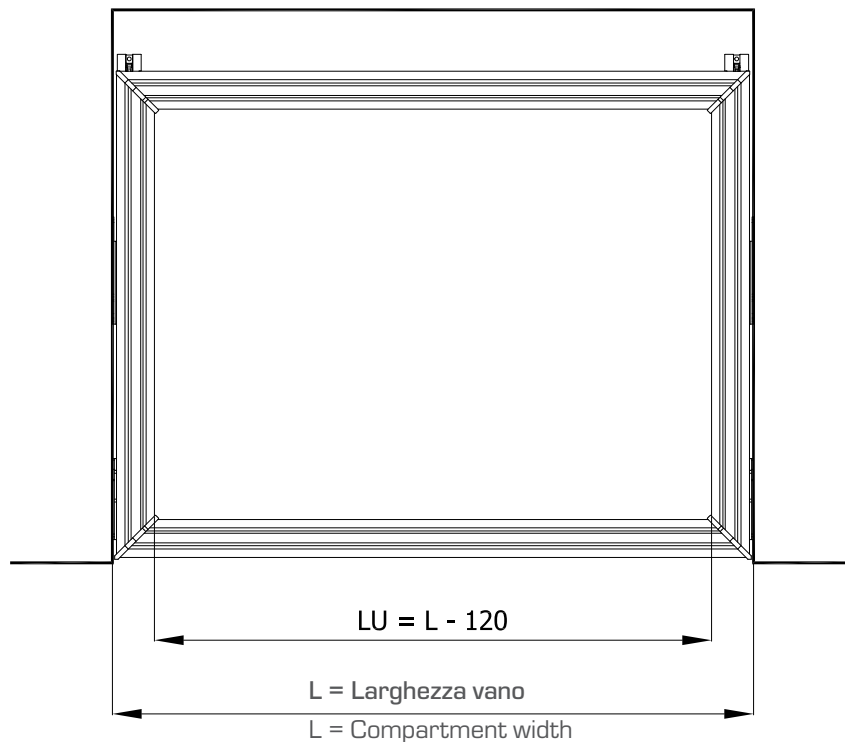

ATTENZIONE: la somma degli ingombri degli accessori (IA) deve essere inferiore alla Larghezza Telaio utilizzabile (Lu)
N.B.: the sum of the dimensions of the accessories (IA) must not exceed the usable Frame Width (Lu)

1. Portapantaloni | Trouser rack

Per configurare il portapantaloni della gamma PAPILLON, si proceda come segue:
 To configure the PAPILLON range trouser rack, proceed as follows:

A) telaio estensibile: scegliere il telaio estensibile (vedi pag. 33)

A) adjustable frame: choose adjustable frame (see page 33) among the three dimensions

B) accessorio: tubi portapantaloni

B) accessory: trouser rack tubes

L'articolo è composto da tubetti indipendenti, removibili e spostabili su cui alloggiare i pantaloni.
 The item consists of independent, removable and moveable tubes on which to hang trousers.

I tubetti sono forniti completi di anelli antiscivolo ed ogni set comprende 4 tubetti.

The tubes come complete with non-slip rings and each set includes 4 tubes.



Max 2.5 kg /tubetto
 Max 2.5 kg /tube

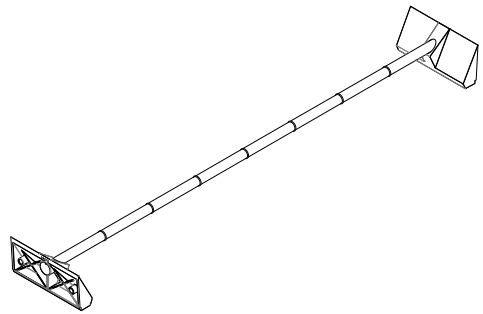

* Immagine esemplificativa

* Example

Portapantaloni configurato come segue:

Trouser rack configured as follows:

A) telaio estensibile brown

A) brown adjustable frame

B) n.2 set accessorio tubi portapantaloni

B) no. 2 sets trouser rack tubes accessory

| Packaging | Finitura Finish | Articolo Item |
|------------------------------------|---|-----------------|
| 1 Set= 4 tubetti 1 Set= 4 tubes | Bianco White  | PA4P00400 |
| 1 Set= 4 tubetti 1 Set= 4 tubes | Brown Brown  | PA4P00B00 |
| 1 Set= 4 tubetti 1 Set= 4 tubes | Piombo Anthracite  | PA4P00P00 |

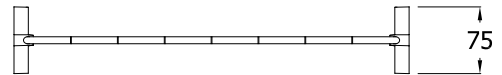

Ogni elemento portapantaloni occupa 75mm (IA) della Larghezza Telaio Utilizzabile (Lu)

Each trouser rack element occupies 75 mm (IA) of the Usable Frame Width (Lu)

Formula per il calcolo dei set:

Formula for calculating sets:

| Numero di pezzi Number of pieces | Ingombro accessori Accessory dimensions (IA) | Misura vano MIN Compartment size MIN (IA + 120mm) |
|-------------------------------------|--|---|
| 4 pz = 1 Set | 300 mm | 420 mm |
| 8 pz = 2 Set | 600 mm | 720 mm |
| 12 pz = 3 Set | 900 mm | 1.020 mm |

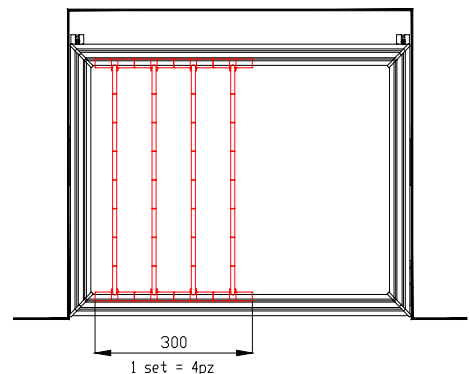

2. Portascarpe | Shoe rack

Per configurare il portascarpe della gamma PAPILLON, si proceda come segue:
To configure the PAPILLON range shoe rack, proceed as follows

A) telaio estensibile: scegliere il telaio estensibile (vedi pag. 33)
A) adjustable frame: choose adjustable frame (see page 33)

B) accessorio: vaschette portascarpe
B) accessory: shoe rack tray

L'articolo è composto da moduli indipendenti, removibili e spostabili su cui alloggiare le scarpe.
The item consists of independent, removable and moveable modules in which to store shoes.

Si possono accostare i moduli fino ad ottenere la larghezza desiderata; il profilo permette di alloggiare le scarpe su due livelli e nelle posizioni schematizzate in seguito (vedi pag. 40).

Modules can be combined to obtain the desired width; the profile makes it possible to accommodate the shoes on two levels and in the positions shown below (see page 40).



Max 4 kg /Modulo
Max 4 kg /module

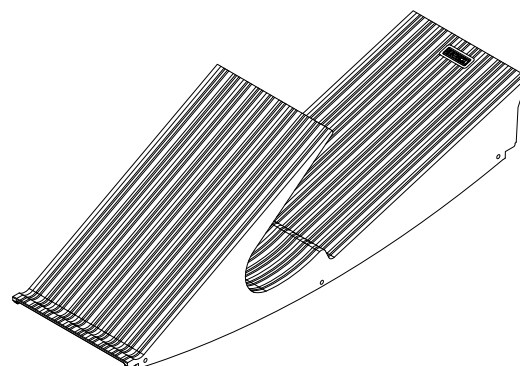

* Immagine esemplificativa.
Example.

Portascarpe configurato come segue:
Shoe holder configured as follows:

A) telaio estensibile brown
A) brown extendable frame

B) n.3 set accessorio vaschette portascarpe
B) no. 3 sets shoe rack tray accessory

| Packaging | Finitura Finish | Articolo Item |
|---------------------------|----------------------------------|---|
| 1 Set= 2pz 1 Set= 2pcs | Trasparente Transparent |  PA5S00T00 |
| 1 Set= 2pz 1 Set= 2pcs | Brown fumè Smoked brown |  PA5S00BF0 |
| 1 Set= 2pz 1 Set= 2pcs | Piombo fumè Smoked anthracite |  PA5S00PF0 |



Ogni elemento porta scarpe occupa 130mm (IA) della Larghezza Telaio Utilizzabile (Lu)

Each shoe tray element occupies 130 mm (IA) of the Usable Frame Width (Lu)

Formula per il calcolo dei set:
 Formula for calculating sets:

| N. di pezzi No. of pieces | Ingombro accessori Accessory dimensions (IA) | Misura vano MIN Compartment size MIN (IA + 120mm) |
|-------------------------------|--|--|
| 2 pz = 1 Set 2 pcs = 1 Set | 260 mm | 380 mm |
| 4 pz = 2 Set 4 pcs = 2 Set | 520 mm | 640 mm |
| 6 pz = 3 Set 6 pcs = 3 Set | 780 mm | 900 mm |
| 8 pz = 4 Set 8 pcs = 4 Set | 1.040 mm | 1.160 mm |

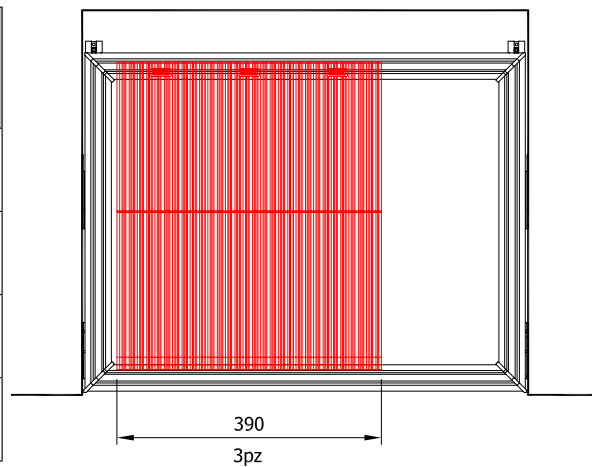

3. Portabiancheria | Laundry basket

Per configurare il portabiancheria della gamma PAPILLON, si proceda come segue:
To configure the PAPILLON range laundry basket, proceed as follows:

A) telaio estensibile: scegliere il telaio estensibile (vedi pag. 33)
A) adjustable frame: choose adjustable frame (see page 33)

B) accessorio: contenitore portabiancheria
B) accessory: laundry basket



Max 4 kg /Modulo
Max 4 kg /module

L'articolo è composto da n.1 modulo indipendente, removibile e spostabile in cui riporre la biancheria. The item consists of no. 1 independent, removable and moveable module in which to gather laundry.

Si possono accostare i moduli fino ad ottenere la larghezza desiderata.

Modules can be combined to obtain the desired width.

1 modulo (set) è composto come segue:

1 module (set) is composed as follows:

n. 2 tubetti (finitura in accordo con il telaio)

no. 2 tubes (finish to match the frame)

n. 1 cesto biancheria (finitura unica)

no. 1 laundry basket (single finish)

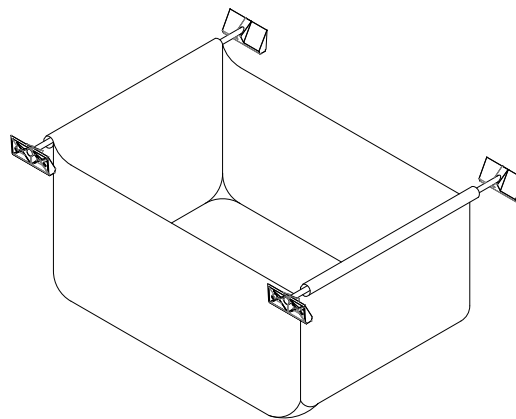

* Immagine esemplificativa.

Example.

Portabiancheria configurato come segue:

Laundry basket configured as follows:

A) telaio estensibile brown | brown extendable frame

B) n.2 set accessorio contenitore portabiancheria | no. 2 sets laundry basket accessory

| Packaging | Finitura Finish | Articolo Item |
|-----------|---------------------|-----------------|
| 1 Set | Bianco White | PA6B00400 |
| 1 Set | Brown Brown | PA6B00B00 |
| 1 Set | Piombo Anthracite | PA6B00P00 |

Ogni elemento porta biancheria occupa 425mm (IA) della Larghezza Telaio Utilizzabile (Lu)

Each laundry basket element occupies 425mm (IA) of the Usable Frame Width (Lu)

Formula per il calcolo dei set:

Formula for calculating sets:

| N. di pezzi No. of pieces | Ingombro accessori (IA) Accessory dimensions (IA) | Misura vano MIN (IA + 120mm) Compartment size MIN (IA + 120 mm) |
|------------------------------|--|--|
| 1 Set | 425 mm | 545 mm |
| 2 Sets | 850 mm | 970 mm |

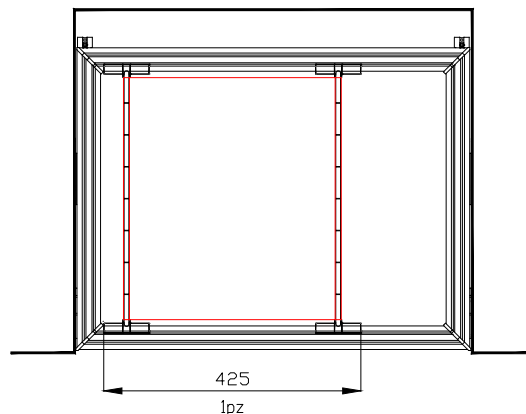

4. Roomy | Roomy box

Roomy è l'accessorio della gamma Servetto, compatibile con il telaio Papillon.
Roomy box, compatible with the Papillon frame.

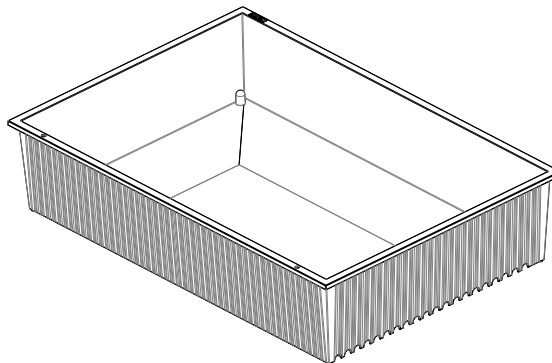

Roomy senza coperchio
Roomy without cover

| Packaging | Finitura Finish | Articolo Item |
|-------------|----------------------------------|-----------------|
| 1 Pz 1 Pc | Trasparente Transparent | ROOMY010T |
| 1 Pz 1 Pc | Brown fumè Smoked brown | ROOMY010F |
| 1 Pz 1 Pc | Piombo fumè Smoked anthracite | ROOMY01PF |

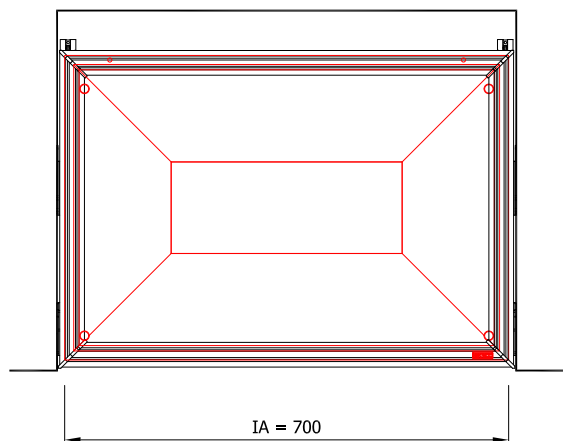

Roomy con coperchio
Roomy with cover



| Packaging | Finitura Finish | Articolo Item |
|-------------|----------------------------------|-----------------|
| 1 Pz 1 Pc | Trasparente Transparent | ROOMY020T |
| 1 Pz 1 Pc | Brown fumè Smoked brown | ROOMY020F |
| 1 Pz 1 Pc | Piombo fumè Smoked anthracite | ROOMY02PF |

Ogni elemento Roomy occupa
700mm (IA) della Larghezza Telaio Utilizzabile (Lu)
Each Roomy element occupies
700 mm (IA) of the Usable Frame Width (Lu)

5. Jolly | Jolly organizer

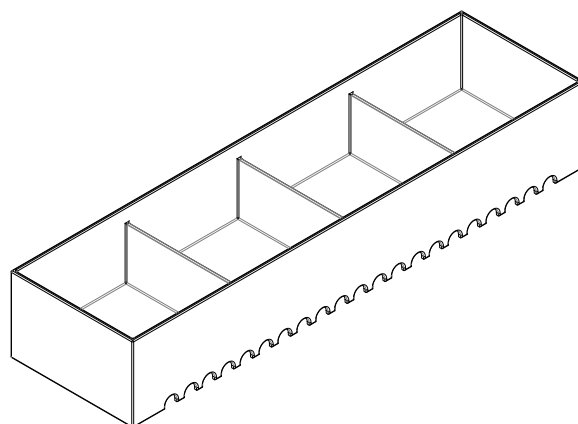
Jolly è l'accessorio della gamma Servetto, compatibile con il telaio Papillon.
The organizer Jolly, compatible with the Papillon frame.



| Packaging | Finitura Finish | Articolo Item |
|-----------|----------------------------------|---|
| 1Pz 1Pc | Trasparente Transparent |  JOLLY0T00 |
| 1Pz 1Pc | Brown fumè Smoked brown |  JOLLYBF00 |
| 1Pz 1Pc | Piombo fumè Smoked anthracite |  JOLLYPF00 |

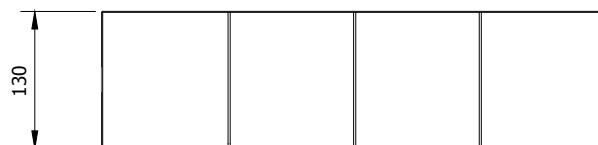

Ogni elemento Jolly occupa
130mm (IA) della Larghezza Telaio Utilizzabile (Lu)
Each Jolly element occupies
130 mm (IA) of the Usable Frame Width (Lu)

Jolly può essere utilizzato in combinazione con gli accessori della gamma Papillon:
Jolly can be used in combination with the accessories of the Papillon range:



Jolly con Portapantaloni
Jolly with Trouser rack



Jolly con Mensola
Jolly with Shelf

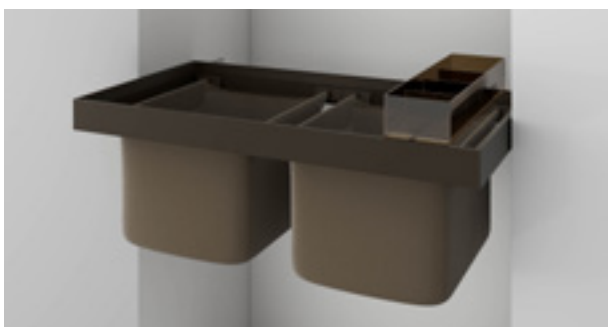

Jolly con Portabiancheria
Jolly with Laundry basket



Jolly with Roomy
Jolly con Roomy



6. Distanziale | Spacer

Lo spessore delle cerniere e/o delle ante può ostacolare la fuoriuscita del telaio Papillon.

The thickness of the hinges and/or doors may obstruct the Papillon frame.

In questo caso si consiglia l'installazione di n.1 o n.2 distanziali in corrispondenza del lato interessato.

In this case we recommend fitting 1 or 2 spacers on the affected side.

| Packaging | Finitura Finish | Articolo Item |
|-------------------------------|---------------------|---|
| 1 Set = 2 pz 1 Set = 2 pcs | Bianco White |  PA7D00400 |
| 1 Set = 2 pz 1 Set = 2 pcs | Brown Brown |  PA7D00B00 |
| 1 Set = 2 pz 1 Set = 2 pcs | Piombo Anthracite |  PA7D00P00 |

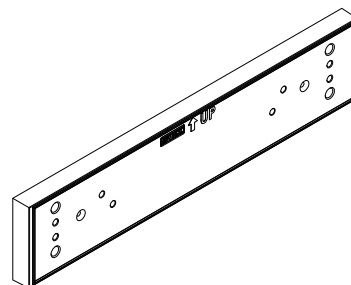

* Il set è comprensivo di viti di fissaggio

* The set includes screws

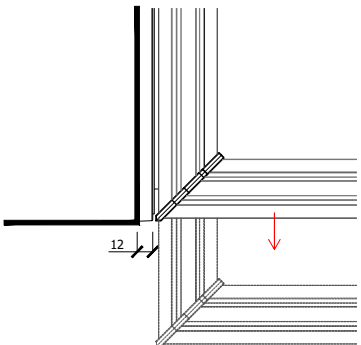
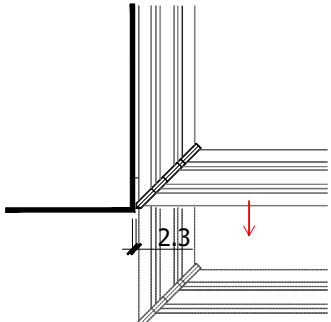
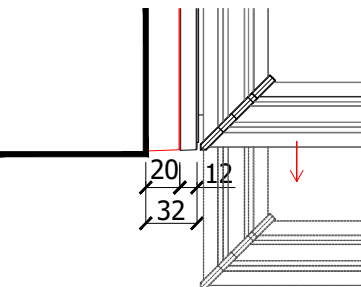
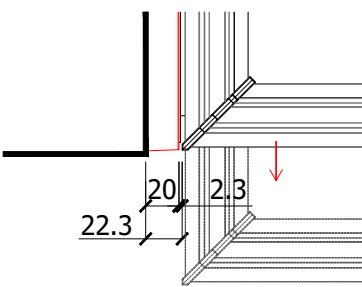
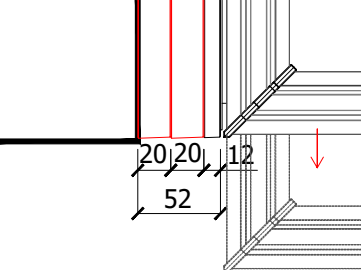
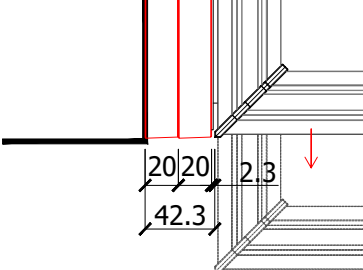
| N. distanziali No. spacers | Guida Blum / Hettich Blum / Hettich runner | Guida Häfele / Grass Häfele / Grass runner |
|-------------------------------|--|---|
| 0 |  <p>12 = spazio per fuoriuscita telaio 12 = space for frame</p> |  <p>2.3 = spazio per fuoriuscita telaio 2.3 = space for frame</p> |
| 1 |  <p>32 = spazio per fuoriuscita telaio 32 = space for frame</p> |  <p>22.3 = spazio per fuoriuscita telaio 22.3 = space for frame</p> |
| 2 |  <p>52 = spazio per fuoriuscita telaio 52 = space for frame</p> |  <p>42.3 = spazio per fuoriuscita telaio 42.3 = space for frame</p> |

7. Compensatore | Compensator

La sponda frontale del telaio estensibile è divisa in tre parti, non tutte alla stessa quota.
The front side of the extendable frame is divided into three parts which are not all at the same height.

Per risolvere lo scompenso, si può utilizzare l'accessorio compensatore per avere tutto alla stessa quota di appoggio (in rosso nella figura).
To level them off you can use the compensator to bring them into line (in red in the figure).

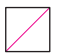
| Packaging | Finitura Finish | Articolo Item |
|---------------------------------|----------------------------|---|
| 1 Set = 10 pz 1 Set = 10 pcs | Trasparente Transparent |  PA8C00T00 |

Nella confezione del fronte+retro per telaio estensibile (confezione 2) sono inclusi n.4 compensatori.
No. 4 compensators are included in the front+back for adjustable frame pack (pack 2).

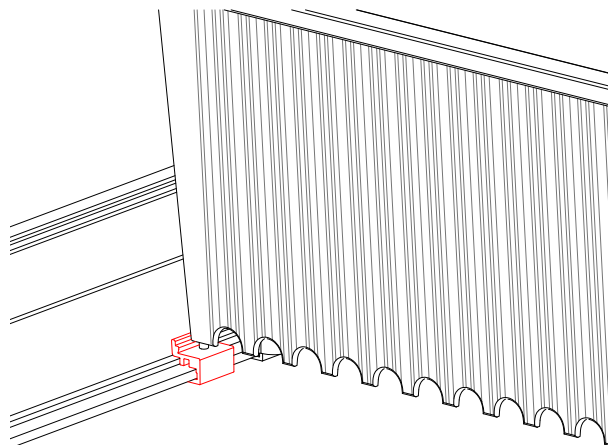
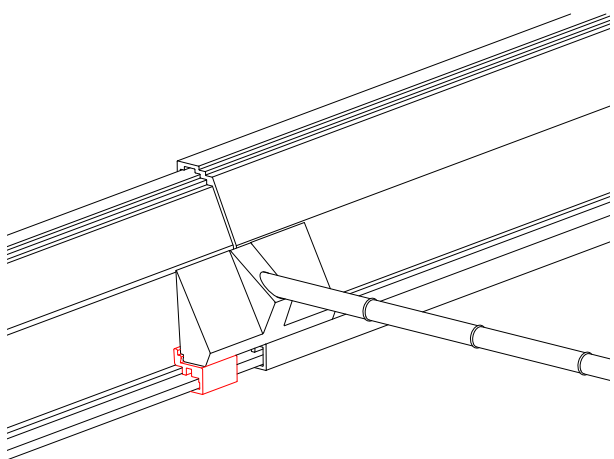
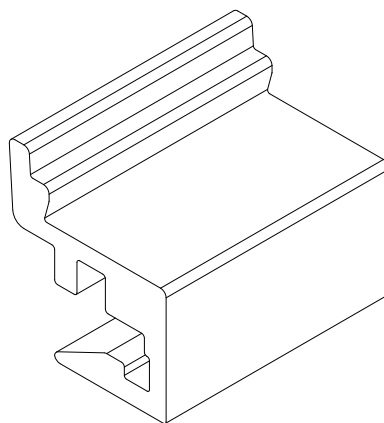
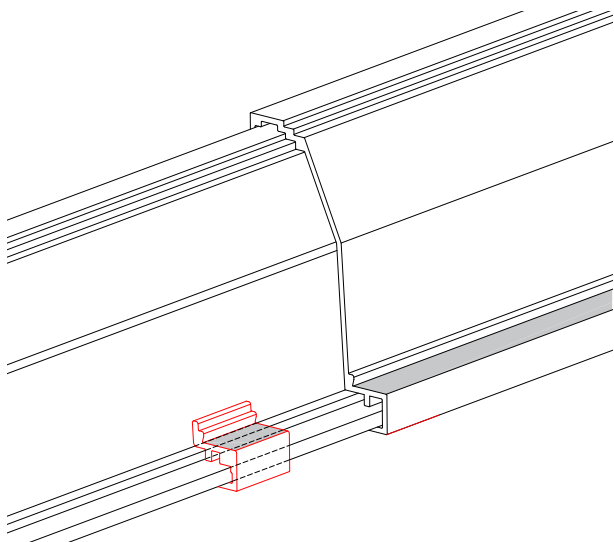

Telaio: estensibile
Frame: adjustable

Accessorio: portapantaloni
Accessory: trouser rack

Telaio: estensibile
Frame: adjustable

Accessorio: Roomy
Accessory: Roomy

Alcune idee... | A few ideas...

Papillon è un sistema molto versatile e si possono ottenere numerose combinazioni a seconda della larghezza del vano che si ha a disposizione. In seguito alcuni suggerimenti.

Papillon is a very versatile system and numerous combinations are possible depending on the width of the compartment. Below are a few suggestions.

I. Papillon + Roomy + Jolly



Composizione:

1. Telaio (capitolo A)
2. Roomy* (capitolo B)
(Ingombro Accessorio = 700mm)
3. Jolly (capitolo B)
(Ingombro Accessorio = 130mm)

Composition:

1. Frame (part A)
2. Roomy* (part B)
(Accessory Footprint = 700 mm)
3. Jolly (part B)
(Accessory Footprint = 130 mm)

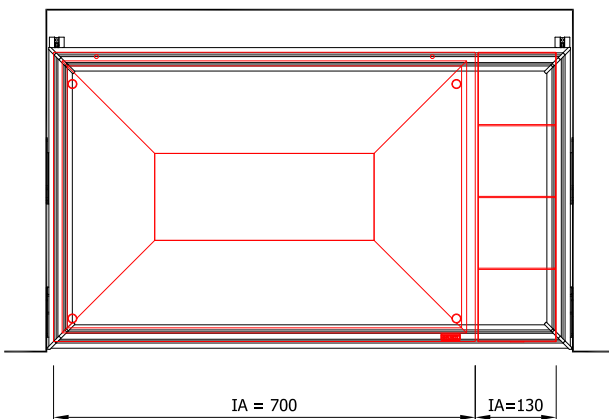

Misura vano MINIMA:

IA + 120mm = 950mm

700 (Roomy) + 130 (Jolly) + 120 = 950mm

*L'accessorio Roomy è inteso CON o SENZA coperchio

MINIMUM compartment size:

IA + 120 mm = 950 mm

700 (Roomy) + 130 (Jolly) + 120 = 950 mm

*The Roomy accessory WITH or WITHOUT cover

Per procedere all'ordine della composizione rappresentata, i codici sono i seguenti:

To order the above composition use the following codes:

| Quantità Quantity | u.m. | A telaio frame | B accessorio accessory | Articolo Item | Finitura Finish | Codice Code |
|----------------------|----------|----------------------|------------------------------|--|--------------------|----------------|
| 1 | Set | ✓ | | spondine laterali dx+sx right + left sides | Brown | PA1S00B00 |
| 1 | Set | ✓ | | fronte+retro per telaio estensibile LARGE front+back for LARGE adjustable frame | Brown | PA2FLAB00 |
| 1 | Set | ✓ | | Adattatori guide (es. BLUM) Runner adapters (e.g. BLUM) | Brown | PA3ABLB00 |
| 1 | pz pc | | ✓ | Roomy | Brown fumè | ROOMY010F |
| 1 | pz pc | | ✓ | Jolly | Brown fumè | JOLLYBF00 |

II. Papillon + Roomy + Tubetti | Papillon + Roomy + Tubes



Composizione:

1. Telaio (capitolo A)
2. Roomy* (capitolo B)
(Ingombro Accessorio = 700mm)
3. Tubi portapantaloni (capitolo B)
(Ingombro Accessorio = 75mm/cad)

Composition:

1. Frame (part A)
2. Roomy* (part B)
(Accessory Footprint = 700 mm)
3. Trousers rack tubes (chapter B)
(Accessory Footprint = 75 mm each)

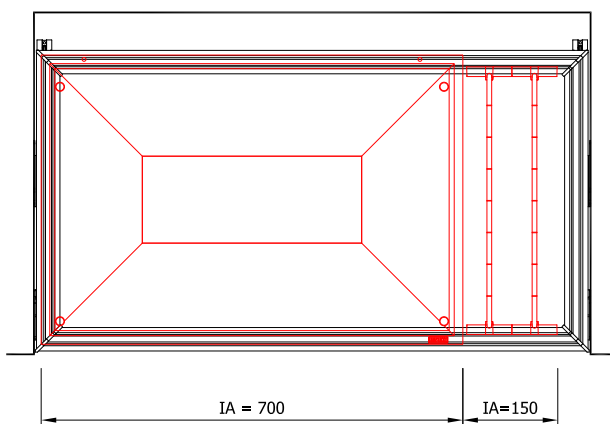

Misura vano MINIMA:

$$IA + 120\text{mm} = 970\text{mm}$$

$$700 \text{ (Roomy)} + 150 \text{ (2 tubetti)} + 120 = 970\text{mm}$$

$$700 \text{ (Roomy)} + 225 \text{ (3 tubetti)} + 120 = 1'045\text{mm}$$

$$700 \text{ (Roomy)} + 300 \text{ (4 tubetti)} + 120 = 1'120\text{mm}$$

MINIMUM compartment size:

$$IA + 120 \text{ mm} = 970 \text{ mm}$$

$$700 \text{ (Roomy)} + 150 \text{ (2 tubes)} + 120 = 970 \text{ mm}$$

$$700 \text{ (Roomy)} + 225 \text{ (3 tubes)} + 120 = 1045 \text{ mm}$$

$$700 \text{ (Roomy)} + 300 \text{ (4 tubes)} + 120 = 1120 \text{ mm}$$

Per procedere all'ordine della composizione rappresentata, i codici sono i seguenti:

To order the above composition use the following codes:

| Quantità Quantity | u.m. | A telaio frame | B accessorio accessory | Articolo Item | Finitura Finish | Codice Code |
|----------------------|------|----------------------|------------------------------|--|--------------------|----------------|
| 1 | Set | ✓ | | spondine laterali dx+sx right + left sides | Brown | PA1S00B00 |
| 1 | Set | ✓ | | fronte+retro per telaio estensibile LARGE front+back for LARGE adjustable frame | Brown | PA2FLAB00 |
| 1 | Set | ✓ | | Adattatori guide (es. BLUM) Runner adapters (e.g. BLUM) | Brown | PA3ABLB00 |
| 1 | pz | | ✓ | Roomy | Brown fumè | ROOMY010F |
| 1 | pz | | ✓ | Tubi portapantaloni Trousers rack tubes | Brown | PA4P00B00 |

III. Papillon + Portabiancheria + Portapantaloni Papillon + Laundry basket + Trouser rack



Composizione:

1. Telaio [capitolo A]
2. Portabiancheria [capitolo B]
(Ingombro Accessorio = 425mm)
3. Tubi portapantaloni [capitolo B]
(Ingombro Accessorio = 75mm/cad)

Composition:

1. Frame (part A)
2. Laundry basket (part B)
(Accessory Footprint = 425 mm)
3. Trouser rack tubes (chapter B)
(Accessory Footprint = 75 mm each)

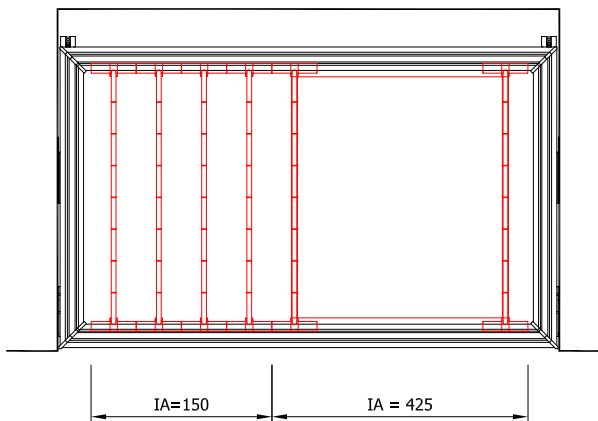

Misura vano MINIMA:

IA + 120mm = 970mm

425 (Portabiancheria) + 150 (2 Tubetti) + 120 = 695mm

425 (Portabiancheria) + 225 (3 Tubetti) + 120 = 770mm

425 (Portabiancheria) + 300 (4 Tubetti) + 120 = 845mm

MINIMUM compartment size:

IA + 120 mm = 970 mm

425 (Laundry holder) + 150 (2 tubes) + 120 = 695 mm

425 (Laundry holder) + 225 (3 tubes) + 120 = 770 mm

425 (Laundry holder) + 300 (4 tubes) + 120 = 845 mm

Per procedere all'ordine della composizione rappresentata, i codici sono i seguenti:
To order the above composition use the following codes:

| Quantità Quantity | u.m. | A telaio frame | B accessorio accessory | Articolo Item | Finitura Finish | Codice Code |
|----------------------|------|----------------------|------------------------------|--|--------------------|----------------|
| 1 | Set | ✓ | | spondine laterali dx+sx right + left sides | Brown | PA1S00B00 |
| 1 | Set | ✓ | | fronte+retro per telaio estensibile LARGE front+back for LARGE adjustable frame | Brown | PA2FLAB00 |
| 1 | Set | ✓ | | Adattatori guide (es. BLUM) Runner adapters (e.g. BLUM) | Brown | PA3ABLB00 |
| 1 | Set | | ✓ | Portabiancheria Laundry basket | Brown | PA6B00B00 |
| 1 | Set | | ✓ | Tubi portapantaloni Trouser rack tubes | Brown | PA4P00B00 |

IV. Papillon + Ripiano | Papillon + Shelf



Composizione:

1. Telaio (capitolo A)
2. Mensola (non fornita da Servetto)

Composition:

1. Frame (part A)
2. Shelf (not supplied by Servetto)

Per procedere all'ordine della composizione rappresentata, i codici sono i seguenti:
To order the above composition use the following codes:

| Quantità Quantity | u.m. | A telaio frame | B accessorio accessory | Articolo Item | Finitura Finish | Codice Code |
|----------------------|------|----------------------|------------------------------|--|--------------------|----------------|
| 1 | Set | ✓ | | spondine laterali dx+sx right + left sides | Brown | PA1S00B00 |
| 1 | Set | ✓ | | fronte+retro per telaio estensibile LARGE front+back for LARGE adjustable frame | Brown | PA2FLAB00 |
| 1 | Set | ✓ | | Adattatori guide (es. BLUM) Runner adapters (e.g. BLUM) | Brown | PA3ABLB00 |

Il cliente può far eseguire la mensola da alloggiare all'interno di Papillon del materiale desiderato.
The shelf to insert in Papillon can be of a material of the customer's choosing.

Le dimensioni del ripiano sono specificate nella scheda tecnica.
The dimensions of the shelf are specified in the data sheet.

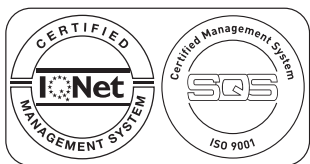

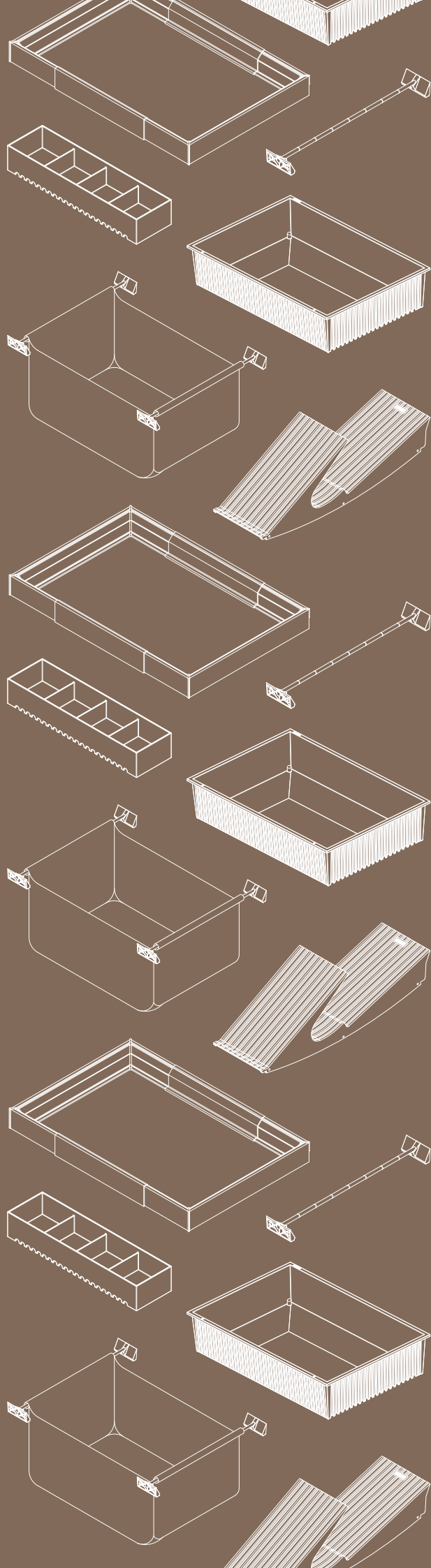

servetto.it

In seguito ad eventuali aggiornamenti e migliorie delle tecniche produttive, l'azienda si riserva la facoltà di apportare modifiche ai prodotti senza alcun preavviso. La Servetto s.r.l. declina ogni responsabilità per l'uso improprio dei prodotti.

Following to any updating or improvements to the productive systems, the company reserves the right to change the products without any advance notice. The company declines all responsibilities for the wrong use of its products.

servetto.it



100% MADE IN ITALY

Via Brughetti, 32
20813 Bovisio Masciago | MB | Italy
tel. +39.0362.55.88.99
info@servetto.it

